

English

Tokyo National Museum

Map and Guide



Welcome to the Tokyo National Museum

Founded in 1872, the Tokyo National Museum (TNM) has the longest history of any museum in Japan. It is home to art and artifacts from across Asia and beyond, including the world's largest and finest Japanese collection.

These holdings are displayed on a rotating basis in six exhibition buildings, which represent nearly a century of Japanese architectural history with their diverse styles. TNM also offers a garden with rare plants and historic teahouses.

With maps, labels, audio guides, and digital content in multiple languages, TNM is dedicated to making its collections and facilities enjoyable to visitors from around the world.

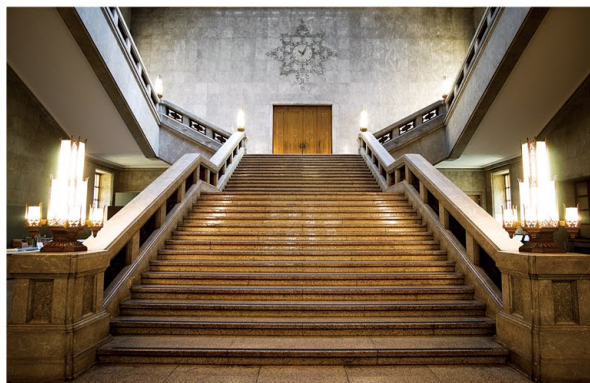

The entrance hall of the Japanese Gallery (Honkan)

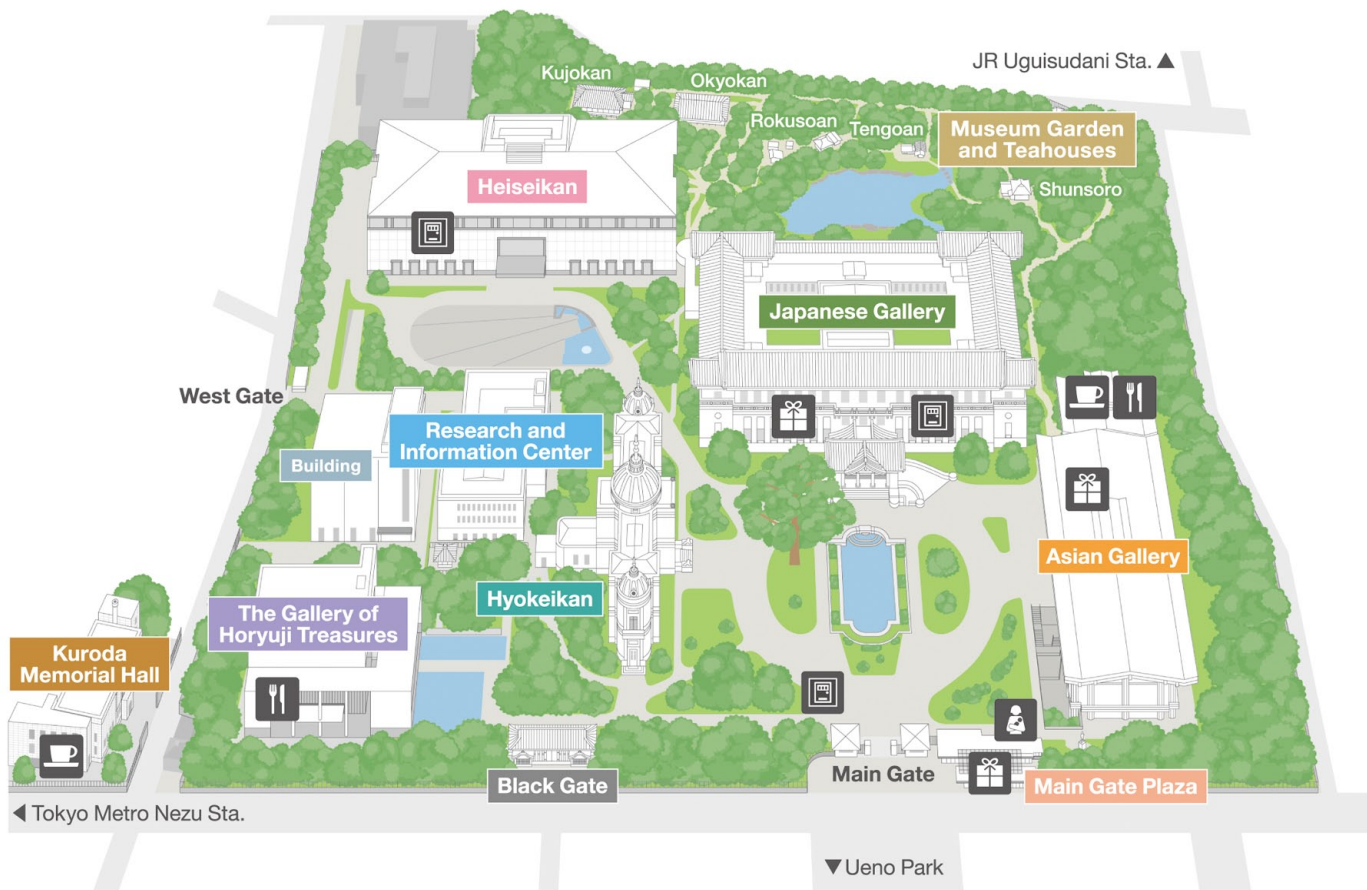

- | | | | | | | | |
|--------------|--------------|-----------------------|--------------------------|--------------|--|---------------------|----------|
| Restroom (M) | Restroom (F) | Restroom (Accessible) | Diaper Change Facilities | Nursing Room | Information | Vending Machines | Elevator |
| Museum Shop | Restaurant | Café | Coin Lockers | Payphone | AED (Automated External Defibrillator) | Ostomate Facilities | |

Japanese Gallery (Honkan)

Important Cultural Property



The 2nd floor presents an overview of Japanese art from prehistory to the 19th century. The 1st floor is organized by genre, such as sculpture and ceramics. The Japanese Gallery was designed by Watanabe Jin (1887-1973) in the Imperial Crown style and opened in 1938.

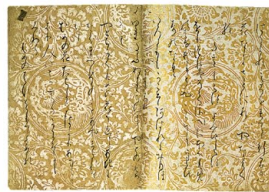

Collection of Japanese Poems Ancient and Modern (Gen'ei-Era Version)

Heian period, 12th century
Gift of Mr. Mitsui Takahiro



Armor (Dōmaru) with "Eurasian-Jay" Lacing, Red at the Top

Muromachi period, 15th century
Gift of Mr. Akita Kazusue

2F

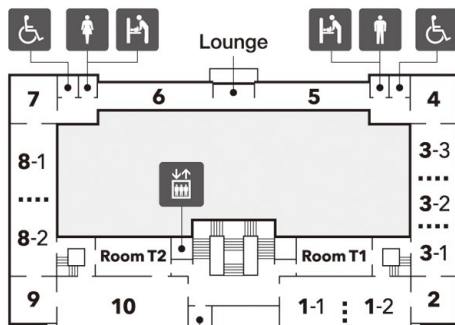

Netsuke: The Prince Takamado Collection

2F Highlights of Japanese Art

- 1-1 : Ancient Art | Ca. 11,000 BC–7th century AD
- 1-2 : The Arrival of Buddhism | 6th–8th century
- 2 : National Treasure Gallery
- 3-1 : The Arts of Buddhism | 8th–16th century
- 3-2 : The Arts of the Imperial Court | 8th–16th century
- 3-3 : Zen and Ink Painting | 13th–16th century
- 4 : Tea Ceremony
- 5•6 : Arms and Armor of the Samurai | 12th–19th century
- 7 : Paintings on Folding Screens and Sliding Doors | 16th–19th century
- 8-1 : Decorative Arts | 16th–19th century
- 8-2 : Painting and Calligraphy | 16th–19th century
- 9 : Performing Arts
- 10 : The Art of Fashion | 17th–19th century
The Art of *Ukiyo-e* | 17th–19th century

1F

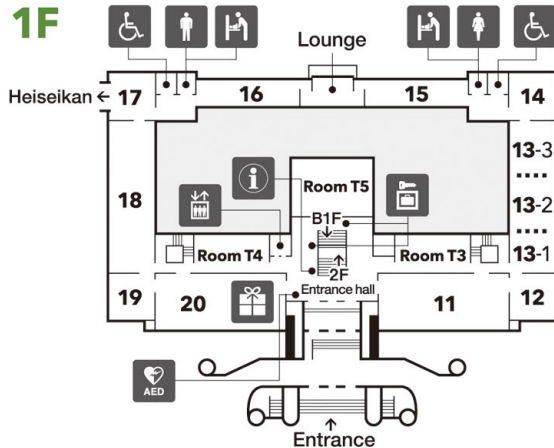

1F Genre Exhibits

- 11 : Sculpture 12 : Lacquerware
- 13-1 : Metalwork 13-2 : Swords 13-3 : Ceramics
- 14 : Thematic Exhibition 15 : Historical Records
- 16 : Ainu and Ryūkyū 17 : Conservation and Restoration
- 18 : Art of the Modern Era | Late 19th–first half of 20th century
- 19 : Education Space 20 : Museum Shop
- Room T3 : *The Door to Japanese Art* (Interactive gallery)
- Room T4 : *Japanese Culture Plaza* (Experience gallery)



Writing Box with the Yatsushashi Bridge

By Ogata Kōrin; lacquered wood with *maki-e* and mother-of-pearl
Edo period, 18th century



Gate Guardian

Heian period, 12th century

B1F

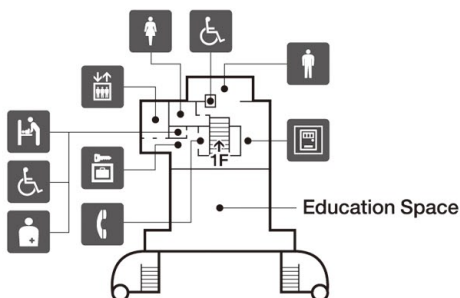

Asian Gallery (Toyokan)



This gallery presents art and artifacts from across Asia and parts of the Middle East. The TNM & TOPPAN Museum Theater is located in the basement. There is also a restaurant with outdoor seating in the annex. The Asian Gallery was designed by Taniguchi Yoshirō (1904-1979) and opened in 1968.



© Red and White Cotton Roses
By Li Di
China, Southern Song dynasty, 1197



© Vase with Dragon Handles
China, Tang dynasty, 8th century
Gift of Dr. Yokogawa Tamisuke

5F

- 9: Chinese Lacquerware, Decorative Art of the Qing Dynasty
- 10: Polished Stone Tools and Metal Tools of Korea
The Rise and Fall of Kings in Korea
Korean Ceramics
Buddhist Art of Korea
Art of the Joseon Dynasty

4F

- 7: Stone Relief Carvings of China
- 8: Chinese Painting and Calligraphy
Chinese Literati

3F

- 4: The Advent of Chinese Civilization
- 5: Chinese Bronzes, Burials in China, Chinese Ceramics, Chinese Textiles
- 6: Education Space:
Fortune-telling in Asia

2F

- 2: Education Space:
Journey Information
- 3: Egypt and Western Asia
Sculptures from India and Gandhara
Art of the Western Regions

1F

- 1: Chinese Buddhist Sculpture

B1F

- 11: Khmer Sculpture
- 12: Gilt Bronze Statues from Southeast Asia
Archaeology of India and Southeast Asia
Southeast Asian Ceramics
- 13: Asian Textiles
Indian Miniature Paintings
Ethnic Cultures of Asia

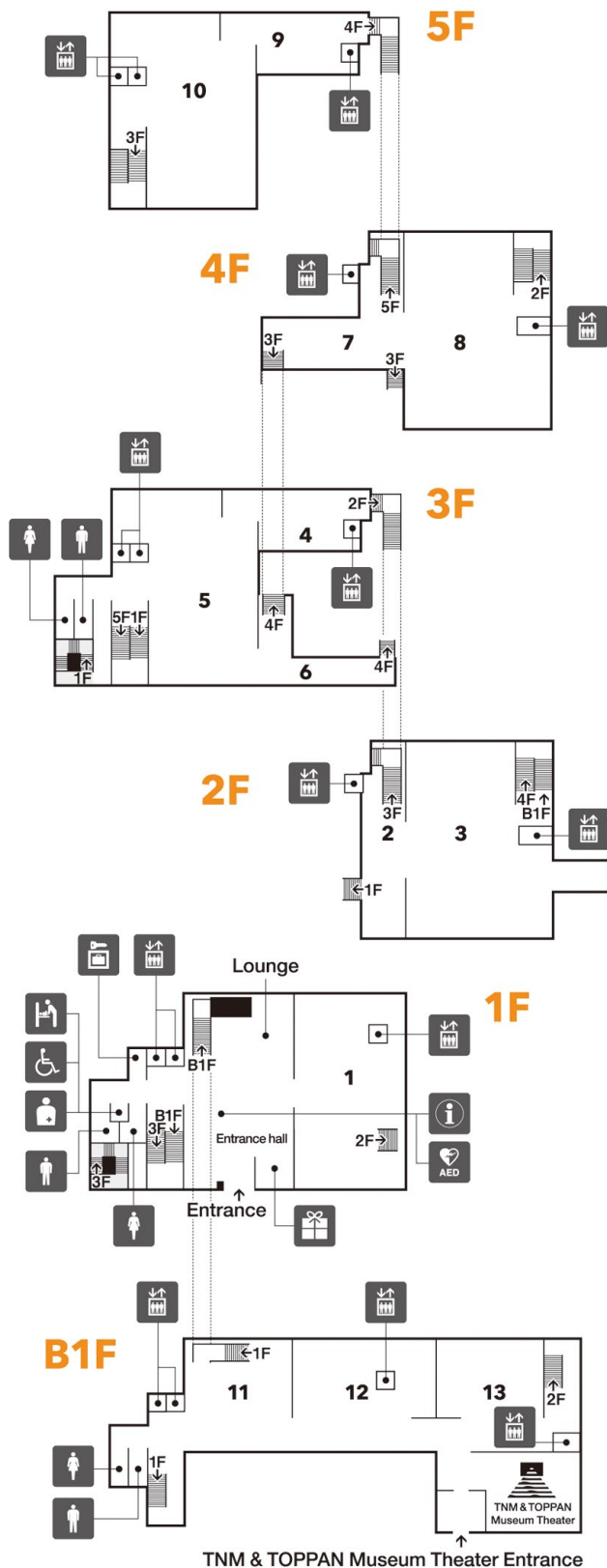

TNM & TOPPAN Museum Theater Entrance

Heiseikan

Japanese Archaeology and Special Exhibitions



Visit the Japanese Archaeology Gallery on the 1st floor to see over 10,000 years of artifacts from Japan's ancient cultures. The 2nd floor features special exhibitions that change throughout the year. Refreshments are available for purchase on the 1st floor.

2F Special Exhibition Gallery

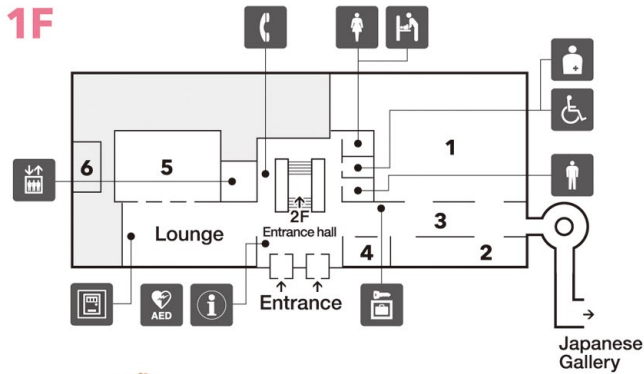
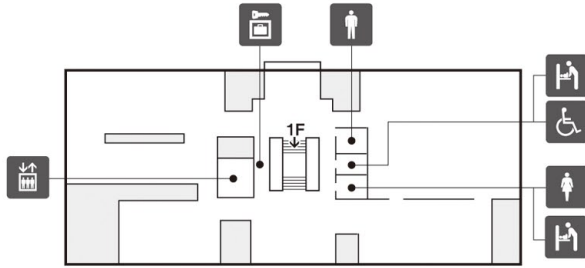

- 1 : Japanese Archaeology Gallery
- 2 : Thematic Exhibition Room
- 3 : Donors' Gallery
- 4 : Orientation Room
- 5 : Auditorium
- 6 : Lecture Room



● Tomb Sculpture (*Haniwa*):
Warrior in *Keikō* Armor
Kofun period, 6th century
Found in Ōta City, Gunma

The Gallery of Horyūji Treasures



The Collection of Hōryūji Treasures includes more than 300 objects, many of which are over 1,300 years old. These objects were passed down at the ancient Buddhist temple Hōryūji and include 14 National Treasures and 239 Important Cultural Properties. The building was designed by Taniguchi Yoshio (born 1937) and opened in 1999. A restaurant is located on the 1st floor.

2F

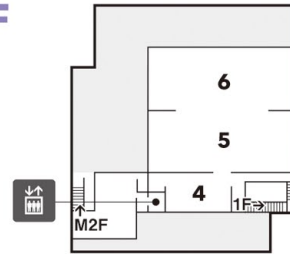

M2F

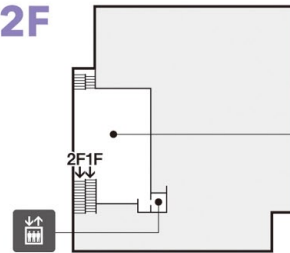

1F

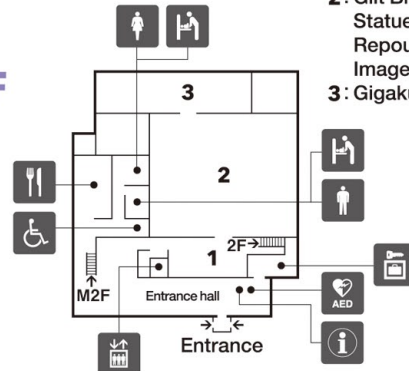

● Pitcher with Dragon Head
Asuka period, 7th century



- 4 : Wooden and Lacquer Works
- 5 : Metalwork
- 6 : Painting, Calligraphy and Textiles

The Digital Gallery of Hōryūji Treasures (Interactive exhibition space)

- 1 : *Kanjō-ban* (Banner for the *kanjō* ceremony)
- 2 : Gilt Bronze Buddhist Statues, Halos, Repoussé Buddhist Images
- 3 : Gigaku Masks

Room 3 is open only on Fridays and Saturdays.

Kuroda Memorial Hall

Registered Tangible Cultural Property



Admission to this building is free. It houses works exclusively by the renowned Japanese oil painter Kuroda Seiki (1866-1924). The Kuroda Memorial Hall was designed by the architect Okada Shin'ichirō (1883-1932) and was built in 1928 in accordance with Kuroda's last will and testament.

2F

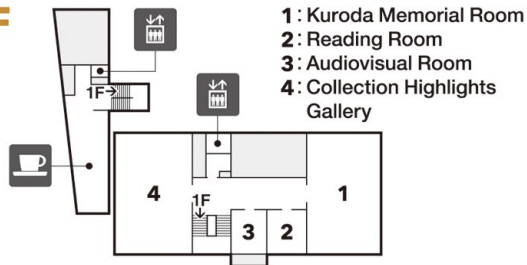

1F

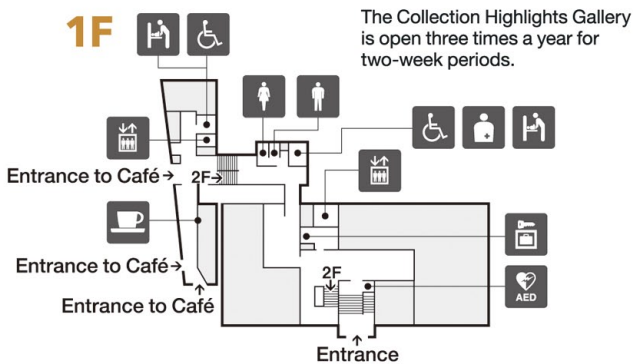

© Lakeside
By Kuroda Seiki; Meiji era, 1897

Restrooms can be found on the basement floor.

Hyokeikan

Important Cultural Property



The Hyokeikan is open for special exhibitions and events. It was designed by Katayama Tōkuma (1854-1917) in the Baroque Revival style to commemorate the wedding of the future Emperor Taishō. Completed in 1909, it is the oldest gallery at the Tokyo National Museum.

Museum Garden and Teahouses



The garden is open all year. In addition to seasonal blooms and fall foliage, there are five historic teahouses within the garden that can be booked for tea ceremonies and other events.

- At times, the garden may be fully or partially closed due to maintenance or poor weather conditions.

Black Gate (Kuromon) Important Cultural Property



This massive structure was once the main gate of a samurai mansion near present-day Tokyo Station. The mansion was owned by the Ikeda clan, which ruled over Tottori domain in western Japan.

Research and Information Center

This building is a reference library containing publications and photographs related to Japanese art, archaeology, and history. Materials cannot be checked out, but are available for browsing and photocopying. Visitors wishing to use only the Research and Information Center must enter via the West Gate (no museum access).

- See the TNM website for admission procedures and opening hours.

Main Gate Plaza

Ticket booths, a nursing room, and other facilities are available.

Restaurants and Cafés

Restaurants and cafés are located in the Gallery of Horyuji Treasures (1F), in the annex adjacent to the Kuroda Memorial Hall (1F/2F), and in the annex adjacent to the Asian Gallery (1F). Visit the TNM website for opening hours.

Museum Shops

(Japanese Gallery 1F, Asian Gallery 1F and Main Gate Plaza)

Gifts and souvenirs include T-shirts, postcards, and other items featuring the museum collection. Exhibition catalogues and other art books are also available. <https://www.tnm-shop.jp/>

TNM & TOPPAN Museum Theater

(Asian Gallery, B1F)

The museum theater uses revolutionary technology to bring visitors face-to-face with celebrated cultural masterpieces. English audio guides are available free-of-charge with purchase of theater admission. See the TOPPAN website for admission procedures and current programs. <https://www.toppa-vr.jp/mt/>

Photography and Other Guidelines



Please refrain from touching any exhibits or showcases.



Please do not use pens, brushes, or mechanical pencils because they may stain or damage the exhibits.



This mark means the owner has prohibited photography of the object. All other objects may be photographed.



Flash, additional lighting, monopods, tripods, and selfie sticks are not allowed in the Museum.



Please turn your electronic devices to silent mode when inside. Phone calls are not permitted in the exhibition rooms.



Food and drinks are not permitted in the galleries. Designated eating areas include the lounge in the Heiseikan and outdoor benches placed around the museum grounds.

All works are from the TNM collection. Due to frequent artwork rotations for conservation purposes, some of the exhibits in this guide may not be on display. Please see the TNM website for works on exhibit and their exhibition periods.

● indicates a National Treasure, ○ an Important Cultural Property.

■ Hours

9:30 am–5:00 pm

- Last admission 30 minutes before closing.
- Opening hours for special exhibitions may differ. See website for details.

■ Closed

The Museum is closed on Mondays and during New Year's holidays. However, if Monday is a holiday, the Museum will be open on that Monday and closed on the following weekday. Subject to change.

■ Admissions (Regular Exhibitions)

Adults: ¥1,000; university students: ¥500

Admission is free for elementary/middle/high school students and persons under 18 or over 70 (please show your passport, driver's license, or other proof of age at the entrance).

- Special exhibitions require a separate admission procedure. See website for details.
- Persons with disabilities are admitted free of charge along with one attendant. Please show official ID or other documentation.
- The regular exhibitions are free on International Museum Day (generally May 18), Respect for the Aged Day (the third Monday of September), and Culture Day (November 3).

■ Visitors with Disabilities and Special Needs

Accessibility maps of the Museum buildings and surrounding areas are available, as well as an access guide from Ueno Station for visually impaired visitors. For more information, please visit the museum website.



Download our free app, TNM Art Guide, for audio guidance and other features.



Free Wi-Fi is available in most areas of the Museum.

SSID: TNM_Free_Wi-Fi Password: 1089wifi



Access

JR Line: 10 minutes from Ueno or Uguisudani Station

Tokyo Metro Line: 15 minutes from Ueno or Nezu Station

Keisei Line: 15 minutes from Keisei Ueno Station

Address: 13-9 Ueno Park, Taito-ku, Tokyo, 110-8712, Japan

TEL: 050-5541-8600 (Hello Dial)

Visit the TNM website for the latest information regarding admission procedures, opening hours, exhibitions, and events. The latest information is also available at the Museum's information counters.

URL <https://www.tnm.jp/>



TNM
website