

January 16–March 10, 2024

Heiseikan, Tokyo National Museum

Organizers: Tokyo National Museum, NHK, NHK Promotions Inc., The Tokyo Shimbun

With the Sponsorship of: Mitsumura Printing Co.,Ltd.

With the Assistance of: Genesis of Japanese Culture & Art



Notes

List of Works

- The same artwork numbers are used in both the catalogue and the galleries, but the works are not displayed in numerical order.
- Key to symbols on illustrations: ● =National Treasure, ◎=Important Cultural Property, ○=Important Art Object.
- Some artworks may be rotated during the exhibition period. Exhibition lineup may change as circumstances require.
- Artworks are on view throughout the exhibition period unless otherwise indicated. The rotation schedule is as follows:

Term① 1/16 (Tue.) – 1/21 (Sun.)	Term⑤ 2/14 (Wed.) – 2/18 (Sun.)
Term② 1/23 (Tue.) – 1/28 (Sun.)	Term⑥ 2/20 (Tue.) – 2/25 (Sun.)
Term③ 1/30 (Tue.) – 2/4 (Sun.)	Term⑦ 2/27 (Tue.) – 3/3 (Sun.)
Term④ 2/6 (Tue.) – 2/12 (Mon.)	Term⑧ 3/5 (Tue.) – 3/10 (Sun.)

Chapter One

The Hon'ami Family Trade and Their Faith in the *Lotus Sutra*

The Sources of Kōetsu's Art

1

Hon'ami Kōetsu

Attributed to Hon'ami Kōho

Edo period, 17th century
Wood

2

Hon'ami KōetsuInscription by Tomioka Tessai; painting by
Kamisaka SekkaTaishō era, 1915
Color on silk
Kōetsuji Temple, Kyoto

3

Seal and Impression: “Kōetsu”

Wood

4

Annals of the Hon'ami FamilyOriginal: Edo period, 17th century; Copy: 1842
Ink on paper
Tessai Museum, Kiyoshikōjin Seichōji Temple, Hyōgo

5

The Hon'ami Family GenealogyEdo period, 18th century
Ink on paper

6

The Kataoka Family GenealogyEdo period, 1759
Ink on paper

7

● Blade for a Long Sword (*Katana*), Named “Meibutsu Kanze Masamune”

By Masamune

Kamakura period, 14th century
Forged steel
Tokyo National Museum

8

● Blade for a Long Sword (*Katana*), Inscribed “Owned by Jō Izumi-no-kami, attributed to Masamune, appraised and shortened by Hon'ami [stylized signature]”

By Masamune

Kamakura period, 14th century
Forged steel with gold inlay
Tokyo National Museum

9

Blade for a Long Sword (*Katana*), Named “Meibutsu Kitano Gō,” Inscribed “Attributed to Gō,**appraised and shortened by Kōtoku [stylized signature]”**

By Yoshihiro

Kamakura–Nanbokuchō period, 14th century
Forged steel with gold inlay
Tokyo National Museum

10

● Blade for a Dagger (*Tantō*)

By Nagashige

Nanbokuchō period, 1334
Forged steel

11

● Blade for a Dagger (*Tantō*), Named “Meibutsu Gotō Tōshirō”

By Yoshimitsu

Kamakura period, 13th century
Forged steel
The Tokugawa Art Museum, Aichi

12

○ Blade for a Dagger (*Tantō*), Named “Meibutsu Torikai Rai Kunitsugu”

By Kunitsugu

Kamakura period, 14th century
Forged steel
Kurokawa Institute of Ancient Cultures, Hyōgo

13

○ Blade for a Dagger (*Tantō*), Inscribed “Hanagatami” (Flower Basket)

By Kaneuji

Kamakura–Nanbokuchō period, 14th century
Forged steel with gold inlay

14

Guardless Dagger Mounting (*Aikuchi Koshigatana*) with Squirrel's Foot FernsEdo period, 17th century
Lacquered wood with carved grooves and *maki-e*

15

◎ Sword Guard with Oak Branches

By Umetada Myōju

Azuchi–Momoyama period, 16th century
Brass and other materials
Hoeido Co., Ltd., Tokyo

16

Certificate of Authenticity (*Origami*)Edo period, 1705
Ink on paper
Kurokawa Institute of Ancient Cultures, Hyōgo

17

Seal: “Hon”Azuchi–Momoyama period, 16th century
Bronze

18

Registry of Celebrated SwordsEdo period, 1779
Ink on paper
Tokyo National Museum

19

Collection of Celebrated SwordsEdo period, 1848
Ink on paper
Tokyo National Museum

20

Work Record of Sword Processing by the Umetada LineageEdo period, 1856
Ink on paper
Tokyo National Museum

21

○ Drawings of Celebrated Swords

By Umetada Jusa

Edo period, 1615
Ink on paper

22

Letter to Toda Kagemasa By Hon'ami KōetsuAzuchi–Momoyama period, 16th century
Ink on paper
Tokyo National Museum

23

Letter to Imaeda ShigenaoBy Hon'ami Kōetsu
Edo period, 17th century
Ink on paper
Kōetsuji Temple, Kyoto

24

Letter Dated the 20th Day of the 1st MonthBy Hon'ami Kōetsu
Edo period, 17th century
Ink on paper

25

Part of a Swordsmith LineageEdo period, 17th century
Ink and gold paint on paper

26

Letter to Jufuku-inBy Hon'ami Kōetsu
Edo period, 17th century
Ink on paper
Enjuji Temple, Fukui

27

Plaque: “Shōchūzan Temple”By Hon'ami Kōetsu
Edo period, 17th century
Wood
Nakayama Hokekyōji Temple, Chiba

28

Plaque: “Myōhokekyōji Temple”By Hon'ami Kōetsu
Edo period, 1627
Wood
Nakayama Hokekyōji Temple, Chiba

29

Plaque: “Honmonji Temple”

By Hon’ami Kōetsu

Edo period, 1627
Wood
Ikegami Honmonji Temple, Tokyo

30

Plaque: “Schoolroom”

Original by Hon’ami Kōetsu

Meiji era, 1869
Wood
Jōshōji Temple, Kyoto

31

Copy of a Sketch Map of Land Granted to Kōetsu

Copy by Kataoka Tadahide/Tadafusa

Edo period, 1654
Ink on paper

32

◎ Nichiren’s Treatise on Establishing the Right Doctrine and Peace for the Nation (*Rissbō Ankokuron*)

By Hon’ami Kōetsu

Edo period, 1619
Ink on paper
Myōrenji Temple, Kyoto

33

◎ Nichiren’s Letter on the Significance of First Hearing the “Buddha Vehicle” (*Shimon Butsujō-gi*)

By Hon’ami Kōetsu

Edo period, 1619
Ink on paper
Myōrenji Temple, Kyoto

34

◎ The Threefold *Lotus Sutra*

Heian period, 11th century
Gold ink on decorated purple paper
Honpōji Temple, Kyoto
①～④ / ⑤～⑧

Chapter Two

Noh Chant Books and Kōetsu Maki-e

Explosive Words and Forms

35

Cherry Trees and Kerria Roses

Calligraphy on poem papers by Hon’ami Kōetsu
Screen paintings attributed to Tawaraya Sōtatsu

Edo period, 17th century
Color on paper
Tokyo National Museum

36

Books of Noh Chants and Poetry Produced by Kanze Motomori and Kanze Sōsetsu

Azuchi-Momoyama period, 16th century
Ink on paper
Kōzan Bunko, Hosei University, Tokyo

37

Books of Noh Chants Reportedly Owned by Matsudaira Izu-no-kami

Edo period, 17th century
Ink on paper
Kōzan Bunko, Hosei University, Tokyo

38

Books of Noh Chants Previously Owned by Ishida Shōzaemon Yūsetsu

Edo period, 17th century
Ink on paper
Kōzan Bunko, Hosei University, Tokyo

39

The Genna Fourth-Month Edition of Noh Chants in One Hundred Volumes

Edo period, 17th century
Woodblock-printed
Dai-tokyu Memorial Library, Tokyo

40

Book of Noh Chants with Postscript by Kanze Tadachika

Edo period, 1606
Mica, ink, and gold and silver paint on paper
The Museum Yamato Bunkakan, Nara
⑤～⑧

41

The Tales of Ise

Edo period, 1608
Woodblock-printed (early movable-type edition)
Dai-tokyu Memorial Library, Tokyo
①～④ / ⑤～⑧

42

Books of Noh Chants Printed in the Calligraphy of Hon’ami Kōetsu

Edo period, 17th century
Woodblock-printed
Kōzan Bunko, Hosei University, Tokyo

43

Books of Noh Chants Printed in the Calligraphy of Hon’ami Kōetsu, Variant Edition

Edo period, 17th century
Woodblock-printed with mica
Kōzan Bunko, Hosei University, Tokyo

44

Books of Noh Chants Printed in the Calligraphy of Hon’ami Kōetsu, Special Edition

Edo period, 17th century
Woodblock-printed with mica
Kōzan Bunko, Hosei University, Tokyo

45

Book of Noh Chants Printed in the Calligraphy of Hon’ami Kōetsu, Variant Edition with Pages in Alternating Colors

Edo period, 17th century
Woodblock-printed with mica
Kōzan Bunko, Hosei University, Tokyo

46

One Hundred Noh Chants

Edo period, 17th century
Ink and mica on paper
Tokyo University of the Arts
①～④ / ⑤～⑧

47

Poems about the Moon from *New Collection of Japanese Poems Ancient and Modern*

Edo period, 17th century
Woodblock-printed
Dai-tokyu Memorial Library, Tokyo
①～④ / ⑤～⑧

48

Letter to Shinbei no Jō

By Hon’ami Kōetsu

Edo period, 17th century
Ink on paper
The Museum Yamato Bunkakan, Nara
①～④

49

Letter (Two Writing Boxes)

By Hon’ami Kōetsu

Edo period, 17th century
Ink on paper
MOA Museum of Art, Shizuoka
⑤～⑧

50

◎ Sutra Box with Floral Vines

By Hon’ami Kōetsu

Edo period, 17th century
Lacquered wood with mother-of-pearl inlay
Honpōji Temple, Kyoto

51

Display Table and Writing Box with *Tachibana* Orange Trees, Pine Trees, Bamboo, Cranes, and Turtles

Azuchi-Momoyama period, 16th–17th century
Lacquered wood with *maki-e*
Kitano Tenmangū Shrine, Kyoto

52

● Footed Chest with Ivy

Azuchi-Momoyama period, 1602
Lacquered wood with *maki-e*
Itsukushima Shrine, Hiroshima

53

◎ Writing Box with Reeds and a Boat

Edo period, 17th century
Lacquered wood with *maki-e*
Tokyo National Museum

54

Writing Box with Motifs from the Sagichō Fire Festival

Edo period, 17th century
Lacquered wood with *maki-e*
Tokyo National Museum

55

● Writing Box with a Pontoon Bridge

By Hon’ami Kōetsu

Edo period, 17th century
Lacquered wood with *maki-e*
Tokyo National Museum

56

○ Writing Box with Squirrel’s Foot Ferns

Edo period, 17th century
Lacquered wood with *maki-e*
Tokyo National Museum

57

◎ Paper Box with a Fan and a Hat for Courty Dances

Edo period, 17th century
Lacquered wood with *maki-e*
Tekisui Museum of Art, Hyōgo

58

◎ Writing Box with a *Bugaku* Performer

Edo period, 17th century
Lacquered wood with *maki-e*
Tokyo National Museum

59

◎ Tiered Shelves with Designs Alluding to *The Tale of Genji*

Edo period, 17th century
Lacquered wood with *maki-e*
Tokyo National Museum

60

Tiered Shelves with the Three Laughers of Tiger Ravine

Attributed to Kōami Chōgen

Edo period, 17th century
Lacquered wood with *maki-e*
Tokyo National Museum

61

Writing Box with Bamboo

Edo period, 17th century
Lacquered wood with *maki-e*
MOA Museum of Art, Shizuoka

62

Writing Box with Plum Blossoms

Edo period, 17th century
Lacquered wood with *maki-e*
Tokyo National Museum

63

Box for Tea Utensils with Butterflies and Indian Goosegrass

Edo period, 17th century
Lacquered wood with *maki-e* and mother-of-pearl inlay
Suntory Museum of Art, Tokyo
①～④

64

Box for the Incense Ceremony with Mount Penglai By Magobei

Edo period, 17th century
Lacquered wood with *maki-e*
Tokyo National Museum

Chapter Three

Line and Form in Kōetsu's Calligraphy A Master of Two-Dimensional Space

65

Letter Replying to the Wife of Shijō Kingo By Nichiren

Kamakura period, 1275
Ink on paper
Tokyo National Museum

66

Nichiren's Buddhist *Waka* Poetry By Hon'ami Kōetsu

Edo period, 1619
Ink on paper
Raku Museum, Kyoto

67

© Nichiren's Treatise on Invoking the Title of the *Lotus Sutra*

By Hon'ami Kōetsu
Edo period, 17th century
Ink on paper
Honpōji Temple, Kyoto
①～④ / ⑤～⑧

68

© Nichiren's Treatise on Practicing the Teachings of the Buddha

By Hon'ami Kōetsu
Edo period, 17th century
Ink on paper
Honpōji Temple, Kyoto
①～④ / ⑤～⑧

69

First Calligraphy of the New Year, Kan'ei 4 By Hon'ami Kōetsu

Edo period, 1627
Ink on paper
Kōetsuji Temple, Kyoto

70

Hiragana Syllabary Poem By Hon'ami Kōetsu

Edo period, 17th century
Ink on paper
①～④

71

Letters to Imaeda Shigenao and Imaeda Naotsune By Hon'ami Kōetsu

Edo period, 17th century
Ink on paper
Maeda Ikutokukai Foundation, Tokyo
①～④ / ⑤～⑧

72

Letter to Katō Akinari By Hon'ami Kōetsu

Edo period, 1615
Ink on paper
Tokyo National Museum

73

Letter to Katō Akinari By Hon'ami Kōetsu

Edo period, 17th century
Ink on paper
Tokyo National Museum

74

Letter to Kichizaemon no Jō

By Hon'ami Kōetsu
Edo period, 17th century
Ink on paper
Kyoto National Museum
①～④

75

Letter to the Tea Bowl Potter Kichiza (Raku Jōkei)

By Hon'ami Kōetsu
Edo period, 17th century
Ink on paper
Raku Museum, Kyoto
⑤～⑧

76

Letter Dated the 3rd Day of the 12th Month

By Hon'ami Kōetsu
Edo period, 17th century
Ink on paper
Naritasan Museum of Calligraphy, Chiba

77

Letter to Kyūenrō (From *the Sekibeki Jō Collection of Letters*, Vol. 1)

By Hon'ami Kōetsu
Edo period, 17th century
Ink on paper
Tokyo National Museum

78

© Deed of Donation for *The Threefold Lotus Sutra*

By Hon'ami Kōetsu
Edo period, 17th century
Ink on paper
Honpōji Temple, Kyoto

79

○ Part of the *Collection of Japanese Poems Ancient and Modern* (One of the “Hon'ami Fragments”)

Attributed to Ono no Tōfū
Heian period, 11th–12th century
Ink on decorated paper
Kyoto National Museum
①～④

80

Part of the *Collection of Japanese Poems Ancient and Modern* (One of the “Hon'ami Fragments”)

Attributed to Ono no Tōfū
Heian period, 11th–12th century
Ink on decorated paper
Tokyo National Museum
⑤～⑧

81

○ Part of the *Collected Poems of Princess Kishi* (One of the “Kojima Fragments”)

Attributed to Ono no Tōfū
Heian period, 11th–12th century
Ink on decorated paper
Tokyo National Museum

82

Part of the *Collection of Beautiful Flowers* (One of the “Yawata Fragments”)

Attributed to Ono no Tōfū

Heian period, 11th century
Ink on decorated paper
Tokyo National Museum

83

One Hundred Poems by One Hundred Poets and Poems by the Thirty-Six Immortal Poets

By Suminokura Soan
Edo period, 17th century
Ink on decorated paper
Tokyo National Museum
①～④ / ⑤～⑧

84

Part of a Compilation of Popular Songs (*Ryūtatsu-Bushi*)

Attributed to Suminokura Soan
Edo period, 1605
Ink on decorated paper
Tokyo National Museum

85

© *Poems by the Thirty-Six Immortal Poets over Paintings of Cranes*

Calligraphy by Hon'ami Kōetsu
Paintings by Tawaraya Sōtatsu
Edo period, 17th century
Ink on decorated paper
Kyoto National Museum

86

Part of *One Hundred Poems by One Hundred Poets* over Paintings of Lotuses

By Hon'ami Kōetsu
Edo period, 17th century
Ink on decorated paper
Suntory Museum of Art, Tokyo
①～③

87

Part of *One Hundred Poems by One Hundred Poets* over Paintings of Lotuses

By Hon'ami Kōetsu
Edo period, 17th century
Ink on decorated paper

88

Part of *One Hundred Poems by One Hundred Poets* over Paintings of Lotuses

By Hon'ami Kōetsu
Edo period, 17th century
Ink on decorated paper
Tokyo National Museum

89

Part of *One Hundred Poems by One Hundred Poets* over Paintings of Lotuses

By Hon'ami Kōetsu
Edo period, 17th century
Ink on decorated paper
④～⑥

90

Part of *One Hundred Poems by One Hundred Poets* over Paintings of Lotuses

By Hon'ami Kōetsu
Edo period, 17th century
Ink on decorated paper
Raku Museum, Kyoto

91

Part of *One Hundred Poems by One Hundred Poets* over Paintings of Lotuses

By Hon'ami Kōetsu
Edo period, 17th century
Ink on decorated paper
⑦⑧

92

New Collection of Japanese Poems Ancient and Modern over Paintings of Birds and Flowering Plants

By Hon'ami Kōetsu

Edo period, 17th century

Ink on decorated paper

①~④ / ⑤~⑧

93

New Collection of Japanese Poems Ancient and Modern over Printed Designs of a Mountain, Pines, and Flowering Plants

By Hon'ami Kōetsu

Edo period, 17th century

Ink on decorated paper

94

Collection of Japanese Poems of a Thousand Years over Printed Designs

By Hon'ami Kōetsu

Edo period, 17th century

Ink on decorated paper

Tokyo National Museum

95

“The Fisherman” (C. “Yu Fu”) from *Songs of Chu* (C. *Chu Ci*)

By Hon'ami Kōetsu

Edo period, 1632

Ink on decorated paper

Chapter Four

Kōetsu's Tea Bowls
Blades of Clay

96

◎ Tea Bowl, Named “Shigure” (Early Winter Rain)

By Hon'ami Kōetsu; Raku ware, black Raku type

Edo period, 17th century

Glazed earthenware

Nagoya City Museum, Aichi

97

◎ Tea Bowl, Named “Amagumo” (Rain Clouds)

By Hon'ami Kōetsu; Raku ware, black Raku type

Edo period, 17th century

Glazed earthenware

Mitsui Memorial Museum, Tokyo

98

Tea Bowl, Named “Murakumo” (Gathering Clouds)

By Hon'ami Kōetsu; Raku ware, black Raku type

Edo period, 17th century

Glazed earthenware

Raku Museum, Kyoto

99

◎ Tea Bowl, Named “Otogoze” (Younger Daughter)

By Hon'ami Kōetsu; Raku ware, red Raku type

Edo period, 17th century

Glazed earthenware

100

○ Tea Bowl, Named “Kamiya”

By Hon'ami Kōetsu; Raku ware, *ame-yū*

(“candy glaze”) Raku type

Edo period, 17th century

Glazed earthenware

101

◎ Incense Container with a Hare

By Hon'ami Kōetsu; Raku ware, red Raku type

Edo period, 17th century

Glazed earthenware

Idemitsu Museum of Arts, Tokyo

102

○ Tea Bowl, Named “Bishamondō”

By Hon'ami Kōetsu; Raku ware, red Raku type

Edo period, 17th century

Glazed earthenware

①②

103

Tea Bowl, Named “Byakko” (White Fox)

By Hon'ami Kōetsu; Raku ware, white Raku type

Edo period, 17th century

Glazed earthenware

Fujita Museum, Osaka

⑥~⑧

104

Tea Bowl, Named “Kansetsu” (Snow Cap)

By Hon'ami Kōetsu; Raku ware, white Raku type

Edo period, 17th century

Glazed earthenware

Raku Museum, Kyoto

①~⑤

105

Tea Bowl, Named “Benzaiten” (Goddess of Wealth)

By Hon'ami Kōetsu; Raku ware, red Raku type

Edo period, 17th century

Glazed earthenware

106

◎ Tea Bowl, Named “Kaga”

By Hon'ami Kōetsu; Raku ware, red Raku type

Edo period, 17th century

Glazed earthenware

Shōkokuji Temple, Kyoto

107

◎ Tea Bowl, Named “Muichimotsu” (With Nothing)

By Chōjirō; Raku ware, red Raku type

Azuchi-Momoyama period, 16th century

Glazed earthenware

Egawa Collection, Hyogo Prefectural Museum of Art

108

Tea Bowl, Named “Mozuya-guro”

By Chōjirō; Raku ware, black Raku type

Azuchi-Momoyama period, 16th century

Glazed earthenware

Raku Museum, Kyoto

109

Tea Bowl, Named “Kinoshita”

By Dōnyū; Raku ware, black Raku type

Edo period, 17th century

Glazed earthenware

Raku Museum, Kyoto

110

◎ Tea Bowl, Named “Nue” (Mythical Chimera-Like Creature)

By Dōnyū; Raku ware, red Raku type

Edo period, 17th century

Glazed earthenware

Mitsui Memorial Museum, Tokyo

HEISEIKAN 2F

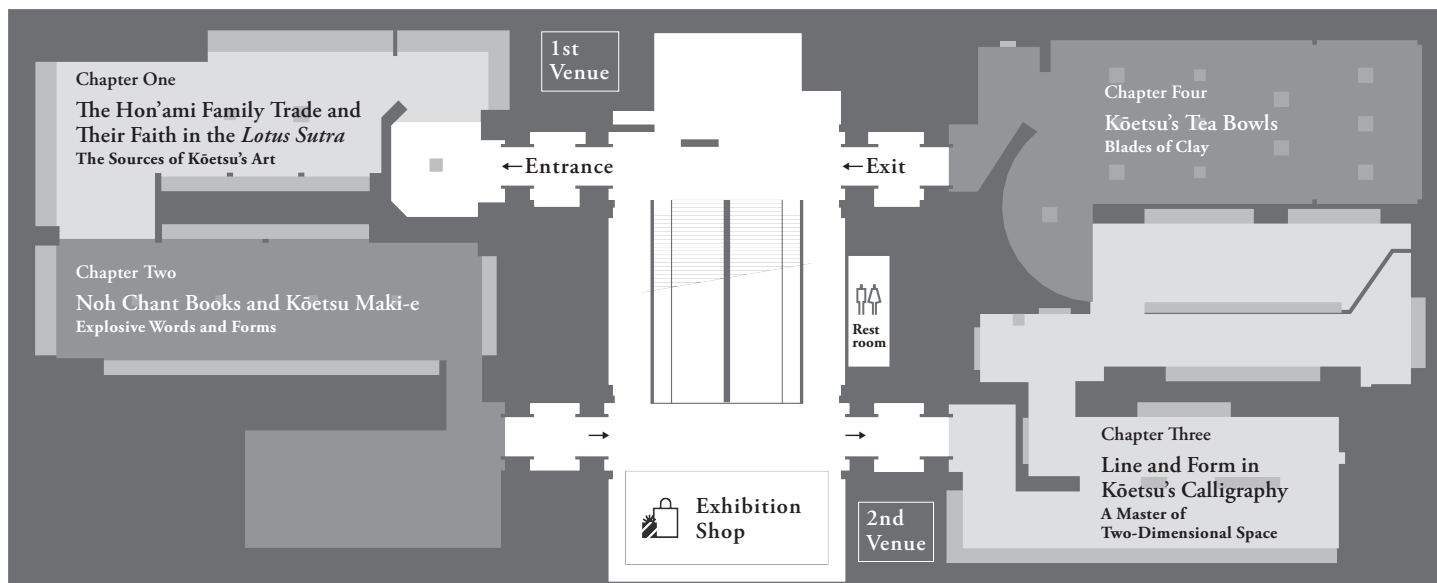

* Temperature, humidity and brightness of the exhibition rooms are strictly controlled under international standards for preservation. We apologize for any inconvenience this may cause.