

TOKYO NATIONAL MUSEUM

ITS HISTORY AND NATIONAL TREASURES

October 18–December 11, 2022
Heiseikan, Tokyo National Museum

Organizers: Tokyo National Museum, The Mainichi Newspapers Co., Ltd., NHK, NHK Promotions Inc., Japan Arts Council, Agency for Cultural Affairs, Government of Japan
With the sponsorship of: East Japan Railway Company, Daishinsha Inc., Daiwa House Industry Co., Ltd., SUMITOMO MITSUI BANKING CORPORATION, Yokogawa Electric Corporation, Yokogawa Bridge Holdings Corp.



Notes

- The same artwork numbers are used in both the catalogue and the galleries, but the works are not displayed in numerical order.
- Key to symbols on illustrations:
●=National Treasure, ◎=Important Cultural Property.
- Some objects may be rotated during the exhibition period. Exhibition lineup may change as circumstances require.
- All works whose holdings are not listed are in the collection of the Tokyo National Museum.
- Works are on view throughout the exhibition period unless otherwise indicated.

The rotation schedule is as follows.

Term ① 10/18(Tue.) -23 (Sun.)	Term ② 10/25(Tue.) -30(Sun.)
Term ③ 11/1(Tue.) -6(Sun.)	Term ④ 11/8(Tue.) -13(Sun.)
Term ⑤ 11/15(Tue.) -20(Sun.)	Term ⑥ 11/22(Tue.) -27(Sun.)
Term ⑦ 11/29(Tue.) -12/4(Sun.)	Term ⑧ 12/6(Tue.) -11(Sun.)

Part One The National Treasures of the Tokyo National Museum

Painting

- 1 ●**
The Sixteen Arhats
Heian period, 11th century
The 1st, 2nd, 5th, and 8th Arhats: Term ①–④
The 12th, 13th, 14th, and 15th Arhats:
Term ⑤–⑧
-
- 2 ●**
The Bodhisattva Fugen
Heian period, 12th century
Term ⑦⑧
-
- 3 ●**
The Peacock Wisdom King
Heian period, 12th century
Term ①–④
-
- 4 ●**
The Bodhisattva Kokūzō
Heian period, 12th century
Term ①–④
-
- 5 ●**
The Thousand-Armed Bodhisattva Kannon
Heian period, 12th century
Term ⑤–⑧
-
- 6 ●**
Bound Fan Papers with the Lotus Sutra
Heian period, 12th century
Term ⑤–⑥/⑦–⑧
-
- 7 ●**
Hell Scroll
Heian period, 12th century
Term ⑤–⑧
-
- 8 ●**
Scroll of Hungry Ghosts
Heian period, 12th century
Term ⑤–⑧
-
- 9 ●**
“The Emperor Escapes to Rokuhara” from *The Illustrated Tale of Heiji*
Kamakura period, 13th century
Term ①②

- 10 ●**
Volume 7 of *Illustrated Biography of the Virtuous Preacher Ippen*
By En'i
Kamakura period, 1299
Term ③④

- 11 ●**
Reading in a Bamboo Grove
Attributed to Shūbun; foreword by Jikūn Tōren; inscriptions by Kōsei Ryūha and four other monks
Muromachi period, 1447
Term ⑤–⑧

- 12 ●**
Broken-Ink Landscape
Painting and foreword by Sesshū Tōyō; inscriptions by Gettō Shūkyō and five other monks
Muromachi period, 1495
Term ⑤–⑧

- 13 ●**
Autumn and Winter Landscapes
By Sesshū Tōyō
Muromachi period, 15th–16th century
Term ①–④

- 14 ●**
Viewing Maple Leaves
By Kanō Hideyori
Azuchi-Momoyama period, 16th century
Term ⑦⑧

- 15 ●**
Cypress Trees
By Kanō Eitoku
Azuchi-Momoyama period, 1590
Term ③–⑥

- 16 ●**
Pine Forest
By Hasegawa Tōhaku
Azuchi-Momoyama period, 16th century
Term ①②

- 17 ●**
Amusements under the Blossoms
By Kanō Naganobu
Edo period, 17th century
Term ①–④

- 18 ●**
Scenes in and around Kyoto (Funaki Version)
By Iwasa Matabei
Edo period, 17th century
Term ⑤–⑧

- 19 ●**
Cooling Off
By Kusumi Morikage
Edo period, 17th century
Term ①–④

- 20 ●**
Landscapes with Pavilions
By Ike no Taiga
Edo period, 18th century
Term ⑤–⑧

- 21 ●**
The Scholar Takami Senseki
By Watanabe Kazan
Edo period, 1837
Term ①–④

Calligraphy

- 22 ●**
Part of the *Sutra on the Wise and Foolish* (Called “*Ōjōmu*”)
Attributed to Emperor Shōmu
Nara period, 8th century
Term ①–④

- 23 ●**
“Expedient Means” Chapter of the *Lotus Sutra* (From Chikubu Island)
Heian period, 11th century
Term ⑤–⑧

- 24 ●**
“Appointment of Enchin as an Attendant Monk by the Ministry of Civil Administration” from *Documents Related to Enchin*
Heian period, 2nd day of the 3rd month of 850
Term ①–④
“Identification Certificates Issued in Taizhou and Wenzhou” from *Documents Related to Enchin*
China, Tang dynasty, 853
Term ⑤–⑧

- 25 ●**
Imperial Decree Granting Enchin a High Rank and Posthumous Name
By Ono no Tōfū
Heian period, 927
Term ①–④

- 26 ●**
Selected Poems of Bai Juyi
By Fujiwara no Kōzei
Heian period, 1018
Term ⑤–⑧

- 27 ●**
Volume 22 of *Qunshu Zhiyao*
Heian period, 11th century
Term ①–④

- 28 ●**
The Autumn Bush-Clover Scroll
Attributed to Ono no Tōfū
Heian period, 11th–12th century
Term ⑤–⑧

- 29 ●**
Ten Styles of Japanese Poetry and Detached Segment
Heian period, 11th century
Term ①–④

- 30 ●**
Record of a Poetry Contest at the Empress' Palace in the Kanpyō Era
Attributed to Prince Munetaka
Heian period, 11th century
Term ⑤–⑧

- 31 ●**
Volume 1 of *Collection of Japanese Poems Ancient and Modern* (Gen'ei-Era Version)
Heian period, 12th century
Term ①–④/⑤–⑧

- 32 ●**
Volume 1 of *Collection of Myriad Leaves*, Revised in the Genryaku Era (Takamatsunomiya Version)
Attributed to Fujiwara no Kōzei
Heian period, 11th century
Term ①–④

33 ●
Volume 1 of *Illustrations and Explanations of the Three Jewels*
Kamakura period, 1273
Term ⑤－⑧

34 ●
“Longevity” Chapter from Volume 26 of *Heart of Medicine (Ishinpō)*
By Tanba no Yasuyori
Heian period, 12th century
Term ①－④

35 ●
Volume 4 of *Engishiki*
Heian period, 11th century
Term ⑤－⑧

Asian Painting

36 ●
Imaginary Journey through Xiaoxiang
By Li
China, Southern Song dynasty, 12th century
Term ⑤－⑧

37 ●
Red and White Cotton Roses
By Li Di
China, Southern Song dynasty, 1197
Term ①－④

38 ●
The Buddha Descending from the Mountain; Snowy Landscapes
Middle and left scrolls by Liang Kai
Right scroll attributed to Liang Kai
Middle and left scrolls: China, Southern Song dynasty, 13th century
Right scroll: China, Southern Song–Yuan dynasty, 13th–14th century
Term ①－④

39 ●
The Eccentrics Hanshan and Shide (From a Scroll of Zen Paintings)
By Yintuoluo
China, Yuan dynasty, 14th century
Term ⑤－⑧

Asian Calligraphy

40 ●
Volume 6 of the *Guwen Shangshu*
China, Tang dynasty, 7th century
Term ①－④

41 ●
Volume 6 of the *Shishuo Xinshu*
China, Tang dynasty, 7th century
Term ⑤－⑧

42 ●
Volumes 29 and 30 of *Collected Writings of Wang Bo*
China, Tang dynasty, 7th–8th century
Term ①－④

43 ●
Solitary Orchid in the Stone-Tablet Mode, No. 5
China, Tang dynasty, 7th–8th century
Term ⑤－⑧

44 ●
Certificate of Recognition for Huqiu Shaolong (Called “The Flotsam Yuanwu”)
By Yuanwu Keqin
China, Northern Song dynasty, 1124
Term ⑤－⑧

45 ●
Letter to the Buddhist Layman Wuxiang
By Dahui Zonggao
China, Southern Song dynasty, 12th century
Term ①－④

46 ●
Letter to the Buddhist Priest Shōichi (Called “The Timber Letter”)
By Wuzhun Shifan
China, Southern Song dynasty, 1242
Term ①－④

47 ●
Buddhist Verse (Called “The Torn Xutang”)
By Xutang Zhiyu
China, Southern Song dynasty, 13th century
Term ⑤－⑧

48 ●
Buddhist Teachings for the Monk Muin Genkai
By Feng Zizhen
China, Yuan dynasty, 14th century
Term ⑤－⑧

49 ●
Buddhist Teachings for the Monk Teki Zōsu
By Liaon Qingyu
China, Yuan dynasty, 1341
Term ①－④

The Hōryūji Treasures

50 ●
Illustrated Biography of Prince Shōtoku
By Hata no Chitei
Heian period, 1069
Panels 7 and 8: Term ①－④
Panels 9 and 10: Term ⑤－⑧

51 ●
Record of the Imperial Bequest to Hōryūji Temple
Nara period, 756
Term ①－④

52 ●
***Lotus Sutra* in Small Characters**
China, Tang dynasty, 694
Term ⑤－⑧

53 ●
Temple Banner for the *Kanjō* Ceremony
Asuka period, 7th century

54 ●
Sutra Box
Nara period, 8th century

55 ●
Mirror with a Waterscape
Nara period, 8th century

56 ●
Stand for Ink Stick; Water Dropper; Spoons
Stand for Ink Stick and Water Dropper: China, Tang dynasty or Japan, Nara period, 8th century
Spoons: China, Tang dynasty or Korea, Unified Silla period, or Japan, Nara period, 8th century

57 ●
Sutra Cabinet
Nara period, 8th century

58 ●
Seven-Stringed *Qin*
China, Tang dynasty, 724

59 ●
Dragon-Head Pitcher
Asuka period, 7th century

60 ●
Incense Burner with a “Magpie-Tail” Handle
Korea, Three Kingdoms period or Japan, Asuka period, 6th–7th century

Archaeology

61 ●
Bronze Bell (*Dōtaku*)
Reportedly found in Kagawa
Yayoi period, 2nd–1st century BC

62 ●
Objects Excavated from the Tōdaijiyama Tumulus
Found in Tenri City, Nara
Sword with an Inscription and Floral Ring Pommel
Blade: China, Eastern Han dynasty, 2nd century
Pommel: Japan, Kofun period, 4th century
House-Shaped Ring Pommel
Kofun period, 4th century

63 ●
Tomb Sculpture (*Haniwa*): Warrior in *Keikō* Armor
Found in Ōta City, Gunma
Kofun period, 6th century

64 ●
Objects Excavated from the Eta Funayama Tumulus
Found in Nagomi Town, Kumamoto
Mirror with a Pictorial Band, Deities, and Beasts
China, Northern and Southern dynasties, 5th–6th century
Earrings
Japan, Kofun period or Korea, Three Kingdoms period, 5th–6th century
Shoes
Korea, Three Kingdoms period, 5th–6th century

65 ●
Objects Excavated from the Tomb of Fumi no Nemaro
Found in Haibara-Yataki, Uda City, Nara
Epitaph of Fumi no Nemaro; Box; Cinerary Urns
Asuka period, 707

66 ●
Ritual Objects Used to Consecrate the Site of Kōfukuji Temple
Found under altar of Central Golden Hall at Kōfukuji Temple, Nara
Japan, Nara period, and China, Tang dynasty, 8th century

Lacquerware

67 ●
Box for Personal Items with Carriage Wheels in Water
Heian period, 12th century
Term ⑤－⑧

68 ●
Box for Personal Items with Carriage Wheels in Water
Kamakura period, 13th century
Term ①－④

69 ●
Writing Box with a Pontoon Bridge
By Hon’ami Kōetsu
Edo period, 17th century
Term ①－④

70 ●
Writing Box with the Yatsushashi Bridge
By Ogata Kōrin
Edo period, 18th century
Term ⑤－⑧

Swords

71 ●
Ceremonial Sword Mounting (*Kazari Tachi*)
Heian period, 12th century

72 ●
Blade for a Long Sword (*Tachi*), Named “*Meibutsu* Mikazuki Munechika”
By Munechika
Heian period, 10th–12th century

73 ●
Blade for a Long Sword (*Tachi*), Named “*Meibutsu* Dōjigiri Yasutsuna”
By Yasutsuna
Heian period, 10th–12th century

74 ●
Blade for a Long Sword (*Tachi*)
By Tomonari
Heian period, 11th–12th century

75 ●
Blade for a Long Sword (*Tachi*), Named “*Meibutsu* Ōkanehira”
By Kanehira
Heian period, 12th century

76 ●
Blade for a Long Sword (*Tachi*)
By Sadatoshi
Kamakura period, 13th century

77 ●
Blade for a Dagger (*Tantō*), Named “*Meibutsu* Atsushi Tōshirō”
By Yoshimitsu
Kamakura period, 13th century

78 ●
Blade for a Long Sword (*Tachi*)
By Kunimitsu
Kamakura period, 1327

79 ●
Blade for a Dagger (*Tantō*)
By Yukimitsu
Kamakura period, 14th century

80 ●
Blade for a Long Sword (*Katana*)
By Masamune
Kamakura period, 14th century

81 ●
Blade for a Long Sword (*Katana*), Named “*Meibutsu* Kanze Masamune”
By Masamune
Kamakura period, 14th century

82 ●
Blade for a Long Sword (*Katana*), Named “*Meibutsu* Kikkō Sadamune”
By Sadamune
Kamakura–Nanbokuchō period, 14th century

83 ●
Chain-Fitted Sword Mounting (*Hyōgo Gusari no Tachi*) with Flocks of Birds, Named “Uesugi Tachi”
By the Ichimonji school
Kamakura period, 13th century

84 ●
Blade for a Long Sword (*Tachi*)
By Sukezane
Kamakura period, 13th century

85 ●
Blade for a Long Sword (*Tachi*)
By Yoshifusa
Kamakura period, 13th century

86 ●
Blade for a Long Sword (*Tachi*), Named “Okadagiri”
By Yoshifusa
Kamakura period, 13th century

87 ●
Blade for a Long Sword (*Tachi*)
By Nagamitsu
Kamakura period, 13th century

88 ●
Blade for a Long Sword (*Tachi*),
Named “Daihannya Nagamitsu”
By Nagamitsu
Kamakura period, 13th century

89 ●
Blade for a Long Sword (*Tachi*),
Named “Koryū Kagemitsu”
By Kagemitsu
Kamakura period, 1322

Part Two
150 Years at the
Tokyo National Museum

Chapter One
The Birth of the Museum

90
Collection of Rare Exhibits from
Ancient and Modern Times
By Ichiyōsai Kuniteru
Meiji era, 1872

91
Mouth Organ (*Shō*) with Bell
Crickets, Named “Suzumushi (Bell
Cricket)”
Kamakura period, 13th century

92
Flute (*Hichiriki*), Named “Higurashi
(Evening Cicada)”
Kamakura period, 13th century

93
Flute (*Ryūteki*), Named
“Sengetsumaru”
Kamakura period, 14th century

94
Saddle with Conch Shells
Edo period, 18th century

95
Stirrups with Dragons Among Clouds
Edo period, 17th–18th century

96
Plaque of the Yamashita-monnai
Museum: “Museum”
By Machida Hisanari
Meiji era, 19th century

97 ●
Volume 2 of *Illustrated Origins of
Kiyomizudera Temple*
By Tosa Mitsunobu
Muromachi period, 1517
Term ① – ④／⑤ – ⑧

98 ●
Tea-Leaf Jar with the Moon and
Plum Blossoms
Studio of Ninsei
Edo period, 17th century

99 ●
Bugaku Mask: *Ryōō*
Passed down at Niutsumi Shrine,
Wakayama
Kamakura period, 13th–14th century

100
Reading Stand with Scenes of Mount
Yoshino
Edo period, 18th century

101 ●
Saddle and Stirrups with Reeds
Azuchi-Momoyama period, 16th century

102
Cannonball for a Mountain Gun
Found in Ueno Park, Tokyo
Edo period-Meiji era, 19th century

103
“Opening of the 1877 National
Industrial Exposition in Ueno Park”
from the Series *Famous Places of
Tokyo*
By Kawanabe Kyōsai
Meiji era, 1877

104
“Art Museum of the National
Industrial Exposition in Ueno Park”
from the Series *Famous Places of
Tokyo*
By Utagawa Hiroshige III
Meiji era, 1877

105
“Art Museum of the Second National
Industrial Exposition in Ueno Park”
from the Series *Famous Places of
Tokyo*
By Utagawa Hiroshige III
Meiji era, 1881

106
Distant View of the Ueno Museum
By Josiah Conder
Meiji era, 19th century

107
Beauty Looking Back
By Hishikawa Moronobu
Edo period, 17th century
Term ① – ④
(Copy: Term ⑤ – ⑧)

108 ●
Surcoat (*Jinbaori*) with Crossed
Scythes
Reportedly used by Kobayakawa Hideaki
Azuchi-Momoyama period, 16th century

109 ●
Footed Bowl with Crabs
By Miyagawa Kōzan I
Meiji era, 1881

110 ●
Eagle
By Suzuki Chōkichi
Meiji era, 1892

Chapter Two
The Imperial Household and the
Museum

111
Entrance Plaque: “Imperial
Household Museum”
Calligraphy by Matano Taku; carved by
Itō Rokusaburō
Meiji era, 1903

112
Imperial Palanquin (*Hōren*)
Edo period, 19th century

113
Formal Court Robes (*Nyōbōshōzoku*)
for an Imperial Princess
Outer Robe (*Uwagi*) with Paired
Butterflies and Linked Diamonds
Multilayered Robe (*Itsutsuginu*)
with Clouds and Wavy Bands
Hair Ornament (*Hirabitai*)
Comb with Chrysanthemums
Folded Paper (*Tatōgami*)
Used by Seikan’ in no Miya (Imperial
Princess Kazu no Miya Chikako)
Edo period, 19th century

114
Two-Tiered Cabinet with Cranes
Carrying Pine Sprigs (From the
Higyōsha Palace)
Edo period, 19th century
Term ① – ④

115 ●
Blade and Mounting for a Straight
Sword (*Chokutō*), Named “Suiryūken”
Nara period, 8th century
Term ⑤ – ⑧

116 ●
Genre Scenes
By Miyagawa Chōshun
Edo period, 18th century

117
Flowers in a Vase
By Kuroda Seiki
Taishō era, 1912

118
Architectural Drawing of the
Hyōkeikan
Meiji era, 1902

119
Flowers and Birds for the Akasaka
Palace
Meiji era, ca. 1906

119-1
Japanese Robin on a Wisteria
By Watanabe Seitei
Term ① – ④

119-2
Pheasant
By Araki Kanpo
Term ① – ④

119-3
Japanese Thrush with a Flowering
Quince and Wild Cherry Tree
By Watanabe Seitei
Term ⑤ – ⑧

119-4
Shrimp and Flounder
By Araki Kanpo
Term ⑤ – ⑧

119-5
Waterhen with Irises
By Watanabe Seitei
Term ① – ④

119-6
Snipes
By Araki Kanpo
Term ① – ④

119-7
Wren with Hydrangeas
By Watanabe Seitei
Term ⑤ – ⑧

119-8
Egrets
By Araki Kanpo
Term ⑤ – ⑧

119-9
Pink Parrot in a Linden Tree
By Watanabe Seitei
Term ① – ④

119-10
Quails with Autumn Grasses
By Araki Kanpo
Term ① – ④

119-11
Dusky Thrush with a Wax Tree and
Gentians
By Watanabe Seitei
Term ⑤ – ⑧

119-12
Geese
By Araki Kanpo
Term ⑤ – ⑧

119-13
Baikal Teal with Reeds and
Chrysanthemums
By Watanabe Seitei
Term ① – ④

119-14
Fowl with Shepherd’s Purse
By Araki Kanpo
Term ① – ④

119-15
Bull-Headed Shrikes with
Camellias and East Asian Alder
By Watanabe Seitei
Term ⑤ – ⑧

119-16
Egret in the Snow
By Araki Kanpo
Term ⑤ – ⑧

120
The Protective Deity Shitsukongōshin (Copy)
By Takenouchi Kyūichi
Meiji era, 1891

121
“Living” Doll (*Iki’ningyō*): Lady-in-
Waiting of the Tokugawa Period
Viewing Cherry Blossoms
Formal Outer Kimono (*Uchikake*)
with Pine Sprigs, Bamboo Leaves,
Plum Blossoms, and Fans
Mid-Layer Kimono (*Aigi*) with
Vines, Wavy Bands, Peonies, and
Long-Tailed Birds
Mid-Layer Sash (*Kakeshita Obi*) with
Cherry Blossoms and Cypress Fans
By Yasumoto Kamehachi III
“Living” Doll: Meiji era, 20th century
Formal Outer Kimono, Mid-Layer Kimono,
and Mid-Layer Sash: Edo period, 19th century

122
Harp (Copy)
Meiji era, 1891

123
Giraffe Taxidermy
Meiji era, 1908
National Museum of Nature and Science

124
Water Jar with a Landscape
Studio of Ninsei
Edo period, 17th century

125
Flower Vase with Peony Vines
Longquan ware, China
China, Yuan dynasty, 13th–14th century

126
Roof Tiles from the Honkan
Ridge-End Tile (*Onigawara*)
Shaped Like the Vermillion Bird;
Round Eave-End Tile; Concave
Eave-End Tile
Shōwa era, 1938

127
A Serpentine Tale
By Noma Seiroku
Shōwa era, 1940
Term ① – ④／⑤ – ⑧

128 ●
Lobed Bowl
Imperial kilns, China
China, Southern Song dynasty, 12th–13th
century

129 ●
Tomb Sculpture (*Haniwa*): House
with Smaller Houses
Found at the Saitobaru Tumuli, Miyazaki
Kofun period, 5th century

130 ●
The Zen Master Ikkyū
By Motsurin Jōtō
Muromachi period, 15th century

131
The Buddha Seated on a Naga
Terrace No. 61 of Southeast Section,
Angkor Thom, Cambodia
Angkor period, 12th century

132
Ukiyo-e Prints from the Matsukata
Collection
132-1 ●
The Actor Ichikawa Danjūrō as
Takenuki Gorō
By Torii Kiyomasu
Edo period, 18th century
Term ① – ④

132-2
Courtesan Holding a Strip of Paper
By Kaigetsudō Dohan
Edo period, 18th century
Term ⑤ – ⑧

132-3
Kabuki “Face-Showing” Performance
By Okumura Masanobu
Edo period, 18th century
Term ① – ④

132-4
The Actors Onoe Kikugorō I and Sanogawa Ichimatsu I as Mendicant Monks
By Ishikawa Toyonobu
Edo period, 18th century
Term ① – ④

132-5
Whisper
By Suzuki Harunobu
Edo period, 18th century
Term ⑤ – ⑧

132-6
Cooling Off under Azuma Bridge
By Torii Kiyonaga
Edo period, 18th century
Term ⑤ – ⑧

132-7 ◎
“The Fickle Type” from the Series *Ten Aspects of Female Physiognomy*
By Kitagawa Utamaro
Edo period, 18th century
Term ① – ④

132-8
“Woman with a Glass Noisemaker” from the Series *Ten Classes of Female Physiognomy*
By Kitagawa Utamaro
Edo period, 18th century
Term ⑤ – ⑧

132-9 ◎
The Actor Ōtani Oniji III as Edobei
By Tōshūsai Sharaku
Edo period, 1794
Term ① – ④

132-10 ◎
The Actor Ichikawa Omezō I as Yakko Ippei
By Tōshūsai Sharaku
Edo period, 1794
Term ⑤ – ⑧

132-11
“Kōraiya” from the Series *Actors on the Stage*
By Utagawa Toyokuni
Edo period, 1794
Term ① – ④

132-12
Girl and Cat at the *Kotatsu* Warmer
By Utagawa Kunimasa
Edo period, 18th–19th century
Term ⑤ – ⑧

132-13
“Under the Wave off Kanagawa” from the Series *Thirty-Six Views of Mount Fuji*
By Katsushika Hokusai
Edo period, 19th century
Term ① – ④

132-14
“Yoshitsune’s Horse-Washing Falls at Yoshino in Washū Province” from the Series *A Tour of Waterfalls in Various Provinces*
By Katsushika Hokusai
Edo period, 19th century
Term ⑤ – ⑧

132-15
Geese and the Moon
By Utagawa Hiroshige
Edo period, 19th century
Term ① – ④

132-16
The Samurai Tametomo Rescued by *Tengu* Sent by Sanukiin
By Utagawa Kuniyoshi
Edo period, 19th century
Term ⑤ – ⑧

**Chapter Three
A New Kind of Museum**

133
Entrance Plaque: “National Museum”
Calligraphy by Abe Yoshishige; carved by Tokunaga Haruo
Shōwa era, 1947

134 ◎
The Wind God and Thunder God
By Ogata Kōrin
Edo period, 18th century
Term ① – ④

135 ◎
Flowering Plants of Summer and Autumn
By Sakai Hōitsu
Edo period, 19th century
Term ⑤ – ⑧

136 ◎
Queen Maya and Heavenly Beings
Asuka period, 7th century

137
Wine Vessel (*Bu*) with Animal Masks (*Taotie*)
China, Shang dynasty, 13th–11th century BC

138
Cruydt-Boeck
By Rembertus Dodonaeus
Antwerp, Belgium
Previously Owned by the Momijiyama Bunko
1644

139 ◎
Clay Figurine (*Dogū*) with Goggle-Like Eyes
Found in Tsugaru City, Aomori
Jōmon period, 1000–400 BC

140 ◎
Noh Costume (*Nuibaku*) with Flowering Plants, Paper Strips, and Yatsushashi Bridges
Passed down by the Mōri Clan
Azuchi-Momoyama period, 16th century

141 ◎
Monk’s Robe (*Kinjō Kesa*)
Reportedly used by Shun’oku Myōha
China, Yuan–Ming dynasty, 14th–15th century

142 ◎
Reiko Smiling
By Kishida Ryūsei
Taishō era, 1921

143
Tea Bowl, Named “Uraku Ido”
Korea
Previously owned by Oda Urakusai and Kinokuniya Bunzaemon
Korea, Joseon dynasty, 16th century

144
Tea Bowl, Named “Furisode (Swinging Sleeves)”
Mino ware, Shino type
Azuchi-Momoyama–Edo period, 16th–17th century

145 ◎
Bell with a Five-Pronged *Vajra* and Seed Syllables
Heian period, 12th century

146
Articulated Dragon
By Myōchin Muneakira
Edo period, 1713

147 ◎
Armor (*Dōmaru*) with “Eurasian-Jay” Lacing, Red at the Top
Muromachi period, 15th century

148 ◎
Pair of Spiral-Wrapped Sword Mountings (*Hirumaki no Daishō*)
Azuchi-Momoyama period, 16th century

149 ◎
Sculpture Traditionally Identified as Minamoto no Yoritomo
Kamakura period, 13th–14th century

150
Gate Guardians
Heian period, 12th century

Floor Plan | Heiseikan 2F

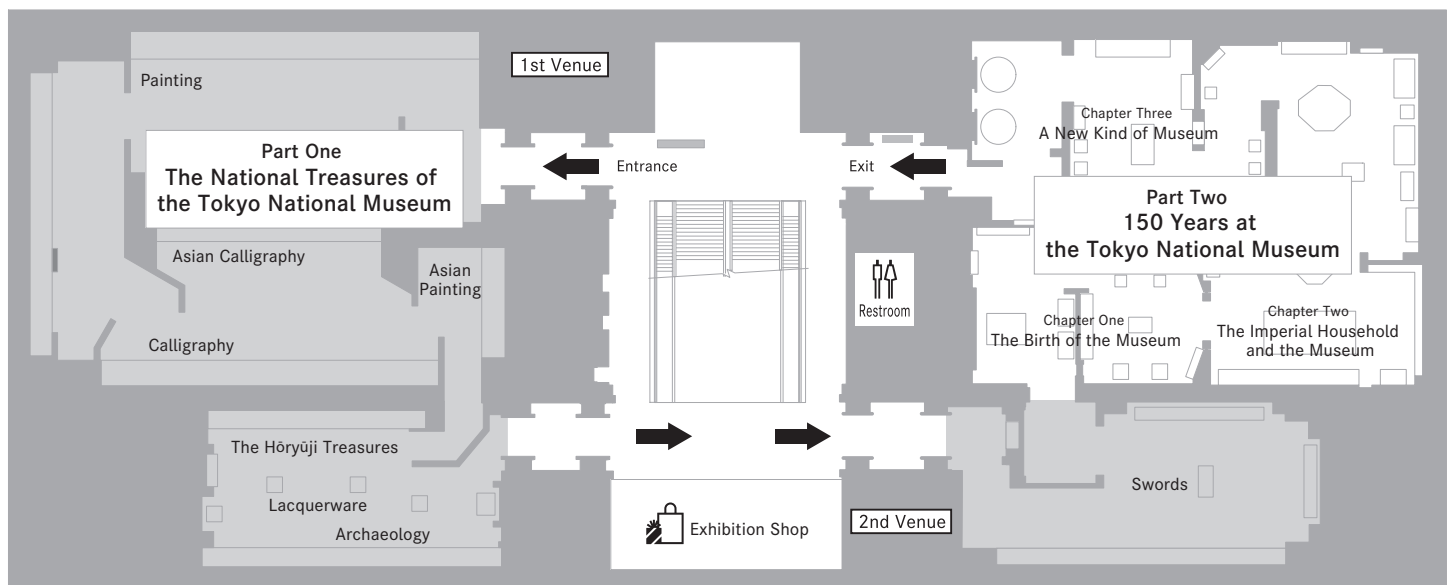

* Temperature, humidity and brightness of the exhibition rooms are strictly controlled under international standards for preservation. We apologize for any inconvenience this may cause.

