

KIMONO

FASHIONING IDENTITIES

List of Works



Notes:

- Exhibition numbers correspond to the catalogue entry numbers. However, the order of the artworks in the exhibition may not necessarily be the same.
- The symbols before the titles mean the following:
 - = National Treasure, ◎ = Important Cultural Property
- Some art works may be rotated during the exhibition period. Exhibition lineup may change as circumstances require.
- The rotation schedule is as follows:
 - ① 6 / 30 (Tue.) — 7 / 5 (Sun.) ② 7 / 7 (Tue.) — 7 / 12 (Sun.)
 - ③ 7 / 14 (Tue.) — 7 / 19 (Sun.) ④ 7 / 21 (Tue.) — 7 / 26 (Sun.)
 - ⑤ 7 / 28 (Tue.) — 8 / 2 (Sun.) ⑥ 8 / 4 (Tue.) — 8 / 10 (Mon.)
 - ⑦ 8 / 12 (Wed.) — 8 / 16 (Sun.) ⑧ 8 / 18 (Tue.) — 8 / 23 (Sun.)
- Works are on view throughout the exhibition period unless otherwise indicated.
- The Metropolitan Museum of Art and The Museum of Fine Arts, Boston were delighted to participate in the Kimono exhibition, but because of the Covid-19 pandemic the shipping of the loans had to be cancelled; Nos. 24, 26, 104–109, 134–139, 145, and 146.

June 30 – August 23, 2020

Heiseikan, Tokyo National Museum

Organizers: Tokyo National Museum, The Asahi Shimbun, TV Asahi Corporation, Agency for Cultural Affairs, and Japan Arts Council

With the Sponsorship of: Takara Leben Co., Ltd., Takenaka Corporation, Toppan Printing Co., Ltd., and Toyota Motor Corporation

With the Assistance of: Kobe Fashion Museum

No.	Title	Artist	Holder	Term
Prologue				
1	● <i>Uwagi</i> (Woman's Formal Ceremonial Outer Court Robe) with Mallows and Phoenixes	Tsurugaoka Hachimangu Shrine, Kanagawa		①–④
2	● <i>Kouchigi</i> (Woman's Formal Outer Court Robe) with Melon Roundels on Checkers	Tsurugaoka Hachimangu Shrine, Kanagawa		⑤–⑧
3	◎ <i>Kosode</i> (Kimono-Shaped Under Robe) with Paulownia and Bamboo		Tokyo National Museum	
Part I The Birth of Fashion				
1. From the Toyotomi to the Tokugawa: Styles of the Azuchi-Momoyama Period and Keichō Era (1573–1615)				
4	◎ <i>Kosode</i> (Kimono) with Birds and Flowers		Tokyo National Museum	⑤–⑧
5	◎ <i>Nuihaku</i> (Kimono) with Quadrants of Seasonal Flowers and Plants		Kyoto National Museum	①–④
6	<i>Kosode</i> Screen [Right panel] Fragments of a <i>Kosode</i> (Kimono) with Checkers and Flowering Plants [Left panel] Fragments of a <i>Kosode</i> (Kimono) with Cherry Blossoms and Wisteria		National Museum of Japanese History, Chiba	
7	● <i>Maple Viewers</i> By Kanō Hideyori		Tokyo National Museum	⑤–⑧
8	<i>Kosode</i> (Kimono) with Hexagons, Cypress Fencing, Wisteria, and Snowflakes		Kyoto National Museum	
9	◎ <i>Scenes in and around the Capital</i> By Kanō Takanobu		Fukuoka City Museum	①–④
10	◎ <i>Nuihaku</i> (Kimono) with Shoulder and Hem Designs of Flowers and Plants		Tokyo National Museum	
11	◎ <i>Nuihaku</i> (Kimono) with Alternating Blocks of Poetry Slips, Eight Bridges, and Snow-Laden Willows		Tokyo National Museum	
12	◎ <i>Kosode</i> (Kimono) with Snow-Laden Tachibana Oranges		Kyoto National Museum	①–④
13	<i>Karaori</i> (Kimono) with Chrysanthemums and Serpentine Columns		J. Front Retailing Archives Foundation Inc., Matsuzakaya Collection, Aichi	⑤–⑧
14	Fragments from a <i>Kosode</i> (Kimono) with Vertical Split Designs of Sandbanks, Flowers, and Plants		Kyoto National Museum	
15	Fragment from a <i>Kosode</i> (Kimono) with Vertical Split Designs of Sandbanks, Flowers, and Plants		Marubeni Corporation, Tokyo	
16	<i>Kosode</i> (Kimono) with Vertical Split Designs of Sandbanks, Flowers, and Plants (Historical Reproduction)		Marubeni Corporation, Tokyo	
17	◎ <i>Nuihaku</i> (Kimono) with Horizontal Bands, Lozenges, Roundels, Flowers, and Plants		Hirano Museum, Shizuoka	①–④

No.	Title	Artist	Holder	Term
18	◎ <i>Nuihaku</i> (Kimono) with Horizontal Bands and Viburnums		Agency for Cultural Affairs	⑤–⑧
19	Portrait of Enchiin Myōjō (Wife of Shinohara Katsutaka)		Myōhōji Temple, Kanazawa, Ishikawa	①②
20	Portrait of a Woman		Tokyo National Museum	③④
21	(Possibly) Portrait of Yododono		Nara Prefectural Museum of Art	⑤–⑧
22	◎ <i>Nuihaku</i> (Kimono) with Floral-Lozenge Hexagonal Pattern		Kōdaiji Temple, Kyoto	①–④
23	<i>Nuihaku</i> (Kimono) with Peonies over Lightning Bolts (Spiral Lozenges)		J. Front Retailing Archives Foundation Inc., Matsuzakaya Collection, Aichi	⑤–⑧
24	<i>Nuihaku</i> (Kimono) with Horizontal Bands of Shells and Seaweed		The Metropolitan Museum of Art, U.S.A.	
2. The Rise of the Floating World: Fashions of the Genna and Kan'ei Eras (1615–1645)				
25	Whose Sleeves? (Disrobed Garments)		Nezu Museum, Tokyo	⑤–⑧
26	Whose Sleeves? (Disrobed Garments)		The Metropolitan Museum of Art, U.S.A.	
27	Whose Sleeves? (Disrobed Garments) with Women		Nezu Museum, Tokyo	②–④
28	● <i>Women Engaged in Leisurely Pursuits</i> (known as the Matsuura Screens)		The Museum Yamato Bunkakan, Nara	①
29	Playing Cards		Art Research Center, Ritsumeikan University, Kyoto	①–④
30	◎ <i>Kosode</i> (Kimono) with Pine Bark Lozenge Bands of Plants and Flowers		Kyoto National Museum	①–④
31	◎ <i>Kosode</i> (Kimono) with Young Pines, Small Flowers, Deer, and Autumn Leaves		Tokyo National Museum	⑤–⑧
32	◎ <i>Kosode</i> (Kimono) with Cranes, Pine, Birds, and Flowers		Agency for Cultural Affairs	①–④
33	◎ <i>Kosode</i> (Kimono) with Imperial Carts, Birds, and Flowers		J. Front Retailing Archives Foundation Inc., Matsuzakaya Collection, Aichi	⑤–⑧
Part II From Kyoto Style to Edo Style				
1. A Revolution in <i>Kosode</i> Fashion: Designs of the Kanbun Era (1661–1673)				
34	<i>Kosode</i> Screen Fragments of a <i>Kosode</i> (Kimono) with Bridge		National Museum of Japanese History, Chiba	①–④
35	House of Pleasure		Suntory Museum of Art, Tokyo	①–④
36	◎ <i>The Rope Curtain</i>		Foundation Arc-en-Ciel, Tokyo	⑤–⑧

No.	Title	Artist	Holder	Term
37	<i>Kosode</i> (Kimono) with Chrysanthemums and Flowing Water		Nara Prefectural Museum of Art	
38	© Kimono Pattern Book from Kariganeya, <i>Manji yonen ongachō</i> (<i>Design Book for 1661</i>)		Osaka City Museum of Fine Arts	
39	Dancing Courtesan		The Museum Yamato Bunkakan, Nara	①–④
40	Standing Beauty		Chiba City Museum of Art	⑤–⑧
41	<i>Furisode</i> (Long-Sleeved Kimono) with Large Chrysanthemum and Small Flowers		Tokyo National Museum	①–④
42	© <i>Katabira</i> (Unlined Summer Kimono) with Fan Palm Chrysanthemums		Kyoto National Museum	⑤–⑧
43	Kimono Pattern Book, <i>Shinsen onhiinakata</i> (<i>Newly Selected Kimono Designs</i>)		Tokyo National Museum	First Volume ①–④ Second Volume ⑤–⑧
44	<i>Kosode</i> (Kimono) with Framed Plaques		National Museum of Japanese History, Chiba	①–④
45	© <i>Kosode</i> (Kimono) with Waves and Mandarin Ducks		Tokyo National Museum	
46	<i>Kosode</i> (Kimono) with Chrysanthemums and Waterfalls		National Museum of Japanese History, Chiba	⑤–⑧
47	<i>Kosode</i> (Kimono) with Water Hyacinths		J. Front Retailing Archives Foundation Inc., Matsuzakaya Collection, Aichi	①–④
48	<i>Kosode</i> (Kimono) with Lacquered Cosmetic Boxes		J. Front Retailing Archives Foundation Inc., Matsuzakaya Collection, Aichi	⑤–⑧
49	Kimono Pattern Book, <i>Genroku Moyō Yosei hiinagata</i> (<i>Lingering Charm Kimono Designs</i>)	By Miyazaki Yūzen	J. Front Retailing Archives Foundation Inc., Matsuzakaya Collection, Aichi	⑤–⑧
50	<i>Kosode</i> Screen [Right panel] Fragments of a <i>Kosode</i> (Kimono) with Bamboo Fence and Calligraphy [Left panel] Fragments of a <i>Kosode</i> (Kimono) with Bamboo Fence, Japanese Larch, and Calligraphy		National Museum of Japanese History, Chiba	⑤–⑧
2. Style Competitions: Fashions of the Genroku Era (1688–1704)				
51	Genre Scenes	By Hishikawa Moronobu		①–④
52	Kimono Fashions	Attributed to Isome Tsuna	Nara Prefectural Museum of Art	⑤–⑧
53	<i>Furisode</i> (Long-Sleeved Kimono) with Autumn Maple Leaves, Bamboo Fence, and “Young Murasaki” Calligraphy from <i>The Tale of Genji</i>		Tokyo National Museum	
54	Obi with Cherry Blossoms and Rafts		Nara Prefectural Museum of Art	
55	<i>Kosode</i> (Kimono) with Moored Boats and Water Plants		National Museum of Japanese History, Chiba	
56	<i>Kosode</i> (Kimono) with Plum Tree and Round-Windowed Building		Joshi University of Art and Design Art Museum, Kanagawa	
57	Kimono Pattern Book, <i>Ogurayama hyakushu hiinagata</i> (<i>One Hundred Poetic Ogura Mountain Kimono Designs</i>)		J. Front Retailing Archives Foundation Inc., Matsuzakaya Collection, Aichi	
58	<i>Kosode</i> (Kimono) with Plum Blossoms and Boats		National Museum of Japanese History, Chiba	①–④
59	<i>Katabira</i> (Unlined Summer Kimono) with Boats and Wisteria		National Museum of Japanese History, Chiba	⑤–⑧
60	<i>Furisode</i> (Long-Sleeved Kimono) with Tachibana Citrus Trees, Bamboo, and Circles		Joshi University of Art and Design Art Museum, Kanagawa	①–④
61	<i>Kosode</i> (Kimono) with Flowing Water, Pine Cones, and Wisteria		Tokyo National Museum	⑤–⑧
62	<i>Kosode</i> (Kimono) with Cherry Tree and Calligraphy		Joshi University of Art and Design Art Museum, Kanagawa	①–④
63	<i>Katabira</i> (Unlined Summer Kimono) with Plum Tree and Fans		Joshi University of Art and Design Art Museum, Kanagawa	⑤–⑧
64	<i>Kosode</i> (Kimono) with Bamboo Hats and Weeping Cherry Branches		National Museum of Japanese History, Chiba	①–④

No.	Title	Artist	Holder	Term
65	<i>Katabira</i> (Unlined Summer Kimono) with Bamboo Blinds and Wisteria		Tokyo National Museum	⑤–⑧
66	Woman Looking over Her Shoulder	By Hishikawa Moronobu	Tokyo National Museum	
67	Woman with Clock	By Nishikawa Sukenobu	Tokyo National Museum	
68	Woman Looking over Her Shoulder	By Hishikawa Morofusa	Nara Prefectural Museum of Art	①–④
69	<i>Kosode</i> Screen Fragments of a <i>Kosode</i> (Kimono) with Poetry Cards with Scenes from <i>The Tale of Genji</i>		National Museum of Japanese History, Chiba	
3. Yūzen: The Emergence of Surface-Dyed Designs				
70	<i>Kosode</i> (Kimono) with Snow-Laden Brushwood Fences and Plum Blossoms		J. Front Retailing Archives Foundation Inc., Matsuzakaya Collection, Aichi	①–④
71	Kimono Pattern Book, <i>Tōryū shippō tokiwa hiinakata</i> (<i>Fashionable Seven Treasures: Ageless Kimono Designs</i>)		J. Front Retailing Archives Foundation Inc., Matsuzakaya Collection, Aichi	①–④
72	<i>Kosode</i> (Kimono) with Treasure Ship		J. Front Retailing Archives Foundation Inc., Matsuzakaya Collection, Aichi	①–④
73	<i>Katabira</i> (Unlined Summer Kimono) with Lattice, Plum Blossoms, Chrysanthemums, and Bush Clover		J. Front Retailing Archives Foundation Inc., Matsuzakaya Collection, Aichi	⑤–⑧
74	<i>Katabira</i> (Unlined Summer Kimono) with Tanabata (Star Festival) Decorations		Kyoto National Museum	⑤–⑧
75	<i>Kosode</i> (Kimono) with Shoreline Scene and Vignettes with Calligraphy of Chapter Titles from <i>The Tale of Genji</i>		Marubeni Corporation, Tokyo	
76	<i>Kosode</i> (Kimono) with Checkers, Calligraphy, and Shrine Festival Floral Umbrellas		J. Front Retailing Archives Foundation Inc., Matsuzakaya Collection, Aichi	①–④
77	<i>Kosode</i> (Kimono) with Wisteria and Flower-Laden Carts		Joshi University of Art and Design Art Museum, Kanagawa	⑤–⑧
78	Courtesan and Attendant under a Cherry Tree	By Miyagawa Chōshun	Nara Prefectural Museum of Art	⑤–⑧
79	Courtesan Enjoying Incense	By Miyagawa Chōshun	Tokyo National Museum	①–④
80	<i>Kosode</i> (Kimono) with Shoji Doors and Chrysanthemums		Fukuoka City Museum	①–④
81	<i>Katabira</i> (Unlined Summer Kimono) with Ginkgo Trees and Books		Nara Prefectural Museum of Art	⑤–⑧
82	© <i>Furisode</i> (Long-Sleeved Kimono) with Bundled <i>Noshi</i> Streamers		Yūzenshi Kai, Kyoto	①–④
83	<i>Kosode</i> (Kimono) with Camellias, Willows, and Hanging Scrolls		Tokyo National Museum	⑤–⑧
84	<i>Kosode</i> (Kimono) with Tea Utensils and Flower Arrangements		J. Front Retailing Archives Foundation Inc., Matsuzakaya Collection, Aichi	
85	<i>Kosode</i> (Kimono) with Incense Utensils, Weeping Cherry, Shoreline Reeds, and Fan Boats		Nara Prefectural Museum of Art	①–④
86	<i>Katabira</i> (Unlined Summer Kimono) with Shoreline Reeds, Boats, and Windblown Leaves		J. Front Retailing Archives Foundation Inc., Matsuzakaya Collection, Aichi	⑤–⑧
87	<i>Kosode</i> (Kimono) with Calligraphy and Scenes of Fushimi Inari Shrine		J. Front Retailing Archives Foundation Inc., Matsuzakaya Collection, Aichi	①–④
88	<i>Kosode</i> (Kimono) with the Eight Views of Lake Biwa		Joshi University of Art and Design Art Museum, Kanagawa	⑤–⑧
89	Kimono Pattern Book, <i>Hiinagata kiku no i</i> (<i>Chrysanthemum Well of Kimono Designs</i>)	By Mutō Ryūshi and others	Tokyo National Museum	⑤–⑧
90	<i>Kosode</i> (Kimono) with Scenes of the Yoshiwara Pleasure Quarters		Joshi University of Art and Design Art Museum, Kanagawa	①–④
91	<i>Kosode</i> (Kimono) with Famous Sites in Kyoto		National Museum of Japanese History, Chiba	⑤–⑧
4. Kōrin Designs: The Craze for Rinpa-Inspired Textiles				
92	© <i>Kosode</i> (Kimono) with Autumn Flowers and Plants	By Ogata Kōrin	Tokyo National Museum	

No.	Title	Artist	Holder	Term
93	<i>Kosode</i> (Kimono) with Wisteria and Shoji Partitions		National Museum of Japanese History, Chiba	
94	Women Enjoying the Evening Cool	By Nishikawa Sukenobu	Tokyo National Museum	①–④
95	Courtesan	By Nishikawa Sukenobu	Fukuoka City Museum	⑤–⑧
96	<i>Kosode</i> (Kimono) with Ivy and Blossoming Plum		J. Front Retailing Archives Foundation Inc., Matsuzakaya Collection, Aichi	
97	<i>Katsugi</i> (Kimono-Shaped Veil) with Large Paulownia Crest, Eight Bridges, and Fiddlehead Ferns		Joshihi University of Art and Design Art Museum, Kanagawa	
98	Illustrated Book, <i>Ehon Minanogawa (Picture Book of the River Minano)</i>	By Nishikawa Sukenobu	Tokyo National Museum	
99	<i>Kosode</i> Screen		National Museum of Japanese History, Chiba	
	[Right panel] Fragments of a <i>Kosode</i> (Kimono) with Autumn Flowers and Plants with Plovers			
	[Left panel] Fragments of a <i>Kosode</i> (Kimono) with Autumn Flowers and Plants, Maple Leaves, and Flowing Water			
100	<i>Kosode</i> (Kimono) with Irises and Eight Bridges		J. Front Retailing Archives Foundation Inc., Matsuzakaya Collection, Aichi	
101	<i>Furisode</i> (Long-Sleeved Kimono) with Rolls of Silk Fabric		J. Front Retailing Archives Foundation Inc., Matsuzakaya Collection, Aichi	①–④
102	<i>Furisode</i> (Long-Sleeved Kimono) with Bamboo Blinds, Pine, and Bush Clover		J. Front Retailing Archives Foundation Inc., Matsuzakaya Collection, Aichi	⑤–⑧
103	Kimono Pattern Book, <i>Tōryū moyō, Hiinagata tsuru no koe (Current Trends in Patterns, Call of the Crane Kimono Designs)</i>		J. Front Retailing Archives Foundation Inc., Matsuzakaya Collection, Aichi	⑤–⑧
5. Edo Minimalism				
104–109	Six Jewel Rivers (<i>Mu Tamagawa</i>)	By Suzuki Harunobu	The Metropolitan Museum of Art, U.S.A	
104	The Jewel River of Kōya (<i>Kōya no Tamagawa</i>)			
105	The Jewel River of Ide (<i>Ide no Tamagawa</i>)			
106	The Jewel River of Chōfu (<i>Chōfu no Tamagawa</i>)			
107	The Cloth-Fulling Jewel River (<i>Tōi no Tamagawa</i>)			
108	The Bush Clover Jewel River (<i>Hagi no Tamagawa</i>)			
109	The Jewel River of Plovers (<i>Chidori no Tamagawa</i>)			
110	<i>Kosode</i> (Kimono) with Scenery amidst Clouds		Fukuoka City Museum	
111	<i>Kosode</i> (Kimono) with Butterflies and Thistles		Toyama Memorial Museum, Saitama	
112	<i>Furisode</i> (Long-Sleeved Kimono) with Irises in Flowing Water		J. Front Retailing Archives Foundation Inc., Matsuzakaya Collection, Aichi	①–④
113	<i>Kosode</i> (Kimono) with Serpentine Columns and Aquatic Plants		J. Front Retailing Archives Foundation Inc., Matsuzakaya Collection, Aichi	⑤–⑧
114	Kimono Pattern Book, <i>Hiinagata Yoshinoyama (Mt. Yoshino Kimono Designs)</i>		J. Front Retailing Archives Foundation Inc., Matsuzakaya Collection, Aichi	⑤–⑧
115	<i>Furisode</i> (Long-Sleeved Kimono) with Origami Cranes and Waves		National Museum of Japanese History, Chiba	①–④
116	<i>Kosode</i> (Kimono) with Willow and Swallows		Fukuoka City Museum	⑤–⑧
117	Kimono Pattern Book, <i>Hiinagata Miyako no Fuji (Mt. Fuji of the Capital Kimono Designs)</i>		J. Front Retailing Archives Foundation Inc., Matsuzakaya Collection, Aichi	
6. The Aesthetic of Iki: Chic Fashions of Edo				
118	<i>Kosode</i> (Kimono) with Towboats		Marubeni Corporation, Tokyo	
119	<i>Kosode</i> (Kimono) with Enshū-style Floral Checkers		Tokyo National Museum	⑤–⑧
120	Kimono Pattern Book, <i>Shin hiinagata chitose sode (New Kimono Designs, Thousand Year Sleeves)</i>		J. Front Retailing Archives Foundation Inc., Matsuzakaya Collection, Aichi	
121	<i>Kosode</i> (Kimono) with Spools of Thread and Koto Zithers			①–④

No.	Title	Artist	Holder	Term
122	<i>Furisode</i> (Long-Sleeved Kimono) with Scenes of Tea Picking		Tokyo National Museum	①–④
123	<i>Hitoe</i> (Unlined Kimono) with Bell Crickets on Autumn Flowers and Plants		Nara Prefectural Museum of Art	⑤–⑧
124	<i>Kosode</i> (Kimono) with Poetry Cards, Poetry Slips, Flowers, and Plants		Joshihi University of Art and Design Art Museum, Kanagawa	①–④
125	<i>Hitoe</i> (Unlined Kimono) with Mount Fuji, Clouds, and Afternoon Rainfall		Nara Prefectural Museum of Art	⑤–⑧
126	<i>Furisode</i> (Long-Sleeved Kimono) with Flowers and Poetry Slips		Nara Prefectural Museum of Art	
127	<i>Furisode</i> (Long-Sleeved Kimono) with Hem Designs of Plovers and Waves		Kyoto Prefectural Government(Under the care of the Museum of Kyoto)	
128	Obi with Peacock Feathers		Nara Prefectural Museum of Art	
129	Obi with Woven Checks		Nara Prefectural Museum of Art	
130	Obi with Floral Arabesque Stripes		Nara Prefectural Museum of Art	
131	Picking Herbs	By Kitao Shigemasa	Tokyo National Museum	
132	Woman with a Cat	By Isoda Koryūsai	Tokyo National Museum	①–④
133	Two Women Enjoying the Evening Cool	By Katsukawa Shungyō	Tokyo National Museum	⑤–⑧
134–139	Current Manners in Eastern Brocade (<i>Fūzoku Azuma no nishiki</i>)	By Torii Kiyonaga		
134	Two Women and a Dozing Maid		The Metropolitan Museum of Art, U.S.A.	
135	Maiden of the Warrior Class with Two Female Attendants		The Metropolitan Museum of Art, U.S.A.	
136	Young Girl and Four Attendants		Museum of Fine Arts, Boston, U.S.A.	
137	An Outing in Spring		Museum of Fine Arts, Boston, U.S.A.	
138	The Kamioki Ceremony		Museum of Fine Arts, Boston, U.S.A.	
139	The Obitoki Ceremony		Museum of Fine Arts, Boston, U.S.A.	
140–146	Summer Outfits: Beauties of Today (<i>Natsu ishō tōsei bijin</i>)	By Kitagawa Utamaro I		
140	Suited to the Fine Ramie Fabrics Stocked by Shirokiya (<i>Shirokiya shiire no jōfu muki</i>)		Tokyo National Museum	⑤–⑧
141	Suited to Patterns Stocked by Izukura (<i>Izukura shiire no moyō muki</i>)		Tokyo National Museum	⑤–⑧
142	Suited to Large-Size Stencil-Dyed Patterns Stocked by Kameya (<i>Kameya shiire no ōgata muki</i>)		Tokyo National Museum	⑤–⑧
143	Suited to Medium-Sized Stencil-Dyed Patterns Stocked by Daimaru (<i>Daimaru shiire no chūgata muki</i>)		Tokyo National Museum	⑤–⑧
144	Suited to Kaga Crests Stocked by Masuya (<i>Masuya shiire no Kaga mon muki</i>)		Tokyo National Museum	⑤–⑧
145	Suited to Dyed Stripes Stocked by Shimaya (<i>Shimaya shiire no some shima muki</i>)		Museum of Fine Arts, Boston, U.S.A.	
146	Suited to Tie-Dyed Fabrics Stocked by Matsuzakaya (<i>Matsuzakaya shiire no shibori muki</i>)		Museum of Fine Arts, Boston, U.S.A.	
147	Women's Hair Ornaments (<i>Kanzashi</i> Hairpins, Combs, <i>Kōgai</i> Ornaments)		Tokyo National Museum	
7. Enterprising Luxury: Clothing Affluent Merchant Women and High-Class Courtesans				
148	Set of Tricolored Bridal <i>Furisode</i> (Long-Sleeved Kimono) with Tachibana Oranges and Books		Marubeni Corporation, Tokyo	
149	<i>Uchikake</i> (Outer Kimono) with Fans on Flowing Water		Bunka Gakuen Costume Museum, Tokyo	

No.	Title	Artist	Holder	Term
150	<i>Uchikake</i> (Outer Kimono) with Bamboo Blinds and Plum Blossoms		Bunka Gakuen Costume Museum, Tokyo	
151	<i>Furisode</i> (Long-Sleeved Kimono) with Alternating Bands of Pine, Bamboo, Plum, Cranes, and Turtles		Joshi University of Art and Design Art Museum, Kanagawa	
152	<i>Furisode</i> (Long-Sleeved Kimono) with Fans		J. Front Retailing Archives Foundation Inc., Matsuzakaya Collection, Aichi	
153	<i>Furisode</i> (Long-Sleeved Kimono) with Bamboo Blind and Children at Play		Marubeni Corporation, Tokyo	
154	Set of Hair Ornaments		Kyoto National Museum	
155	<i>Uchikake</i> (Outer Kimono) and <i>Maru</i> Obi for a <i>Tayū</i>		Wachigaiya, Kyoto	
156	A Courtesan of the Shimabara	By Gion Seitoku	Kyoto Prefectural Government (Under the care of the Museum of Kyoto)	①–④
157	Woman Looking at the Snow	By Yamaguchi Soken	Kyoto Prefectural Government (Under the care of the Museum of Kyoto)	⑤–⑧
158	A Parading Courtesan	By Kikukawa Eizan	Tokyo National Museum	
8. Formal Beauty: Attire for Elite Women of the Warrior Class				
159	<i>Furisode</i> (Long-Sleeved Kimono) with Scenes of Falconry		National Museum of Japanese History, Chiba	
160	<i>Katabira</i> (Unlined Summer Kimono) with Stately Gardens at Night		National Museum of Japanese History, Chiba	
161	<i>Katabira</i> (Unlined Summer Kimono) with Falconry Scene of the Legendary Origins of Kajūji Temple		Nara Prefectural Museum of Art	
162	<i>Koshimaki</i> (Summer Kimono Worn Draped from the Waist) with Plum Blossoms, Camellias, and Floral Lozenges-Filled Hexagons		Tokyo National Museum	
163	<i>Sage</i> Obi (Stiff Sash for Holding a <i>Koshimaki</i>) with Imperial Cartwheels, Wisteria, and Peonies		Tokyo National Museum	
164	<i>Uchikake</i> (Outer Kimono) with Flowing Water, Chrysanthemums, Wild Ginger (<i>Aoi</i>), and Plum Blossoms		Tokyo National Museum	
165	<i>Kakeshita</i> Obi (Sash Worn under an <i>Uchikake</i>) with Anchor and Waves		Tokyo National Museum	
166	“Echigoya ishō hinagata” (Sample Costumes from Echigoya), from Kimono Pattern Book <i>Kosode moyō hinagata mihonchō</i> (<i>Sample Album of Kosode Designs</i>)		Tokyo National Museum	
167	<i>Hitoe</i> (Unlined Kimono) with Chrysanthemums, Drying Rice Sheaves, and Chickens		National Museum of Japanese History, Chiba	
168	Five-Tiered Food Box with Floral Lozenges and Botanical Roundels		Tokugawa Memorial Foundation, Tokyo	
169	Small Chest with Sparrows and Bamboo		Tokugawa Memorial Foundation, Tokyo	
170	Tiered Picnic Box with Sparrows and Bamboo		Tokugawa Memorial Foundation, Tokyo	
171	<i>Akoda</i> Melon-Shaped Incense Burner with Wild Ginger (<i>Aoi</i>) Crests and Arabesques		Tokugawa Memorial Foundation, Tokyo	
172	<i>Uchikake</i> (Outer Kimono) with Wisteria, Chrysanthemums Peonies, and Interlocked Circles		Tokyo National Museum	
173	<i>Kakeshita</i> Obi (Sash Worn under an <i>Uchikake</i>) with Checkers and Branches of Peony and Chrysanthemum		Tokyo National Museum	
174	<i>Fukusa</i> Gift Cover with Sparrows, Bamboo Clappers, and Rice Sheaves		Tokugawa Memorial Foundation, Tokyo	
175	<i>Kosode</i> (Kimono) with Sparrows and Snow-Laden Bamboo		Tokugawa Memorial Foundation, Tokyo	
176	<i>Kakeshita</i> Obi (Sash Worn under an <i>Uchikake</i>) with Sparrows and Rice Sheaves		Tokugawa Memorial Foundation, Tokyo	①–④

No.	Title	Artist	Holder	Term
177	<i>Kosode</i> (Kimono) with Pine, Bamboo, Plum Blossoms, and Drying Nets		Tokugawa Memorial Foundation, Tokyo	①–④
178	<i>Uchikake</i> (Outer Kimono) with Flowing Water, Chrysanthemums, Peonies, and Wisterias		Tokugawa Memorial Foundation, Tokyo	①–④
179	<i>Katabira</i> (Unlined Summer Kimono) with Long-Tailed Birds, Maple Leaves, and Chrysanthemums		Tokugawa Memorial Foundation, Tokyo	⑤–⑧
180	<i>Katabira</i> (Unlined Summer Kimono) with Serpentine Cloud Columns, Peonies, Plum Blossoms, and Wild Ginger (<i>Aoi</i>)		Tokugawa Memorial Foundation, Tokyo	⑤–⑧
181	Pair of Shell Game Containers with Butterflies and Cherry Blossom Arabesques		Tokugawa Memorial Foundation, Tokyo	
182	Folded Papers (<i>Kaishi</i>) Pouch, Pipe Holder, and Tobacco Pouch with Pheasants and Double Blossom Cherries		Tokugawa Memorial Foundation, Tokyo	①–④
183	Folded Papers (<i>Kaishi</i>) Pouch with Sparrows and Maple Leaves		Tokugawa Memorial Foundation, Tokyo	⑤–⑧

Part III Men's Fashion Aesthetics

1. Aesthetics of the Warrior: The Fashions of Nobunaga, Hideyoshi, and Ieyasu

184 *Jinbaori* (Surcoat) with Swallowtail Butterfly

Tokyo National Museum

185 *Jinbaori* (Surcoat) with Lions

Tokyo National Museum

186 ◎ *Dōbuku* Coat with Snowflakes and Ginkgo Leaves

Tokyo National Museum

2. Fashions for *Wakashū*: Long-Sleeved *Yūzen*-Dyed Kimono

187 ◎ *Furisode* (Long-Sleeved Kimono) with Falcons on Freestanding Screens with Plum Trees

Kyoto National Museum

188 *Kosode* (Kimono) with Checkers and Kamo Shrine Horse Race

Kyoto National Museum

189 *Kosode* (Kimono) with Lattice and Banners

J. Front Retailing Archives Foundation Inc., Matsuzakaya Collection, Aich

190 Ogura Mountain Villa

By Okumura Masanobu

Tokyo National Museum

3. The Aesthetic of *Tsū* (Savvy)

191 Man's Chinz *Shitagi* (Mid-Layer Kimono) with Tree Design

J. Front Retailing Archives Foundation Inc., Matsuzakaya Collection, Aichi

192 Man's *Shitagi* (Mid-Layer Kimono) with Famous Sights in Edo

National Museum of Japanese History, Chiba

4. The *Iki* of the Edokko: Firemen's Garments and Kuniyoshi Fashions

193 *Hikeshi Banten* (Fireman's Jacket) with Thunder God

Tokyo National Museum

194 Li Jun, the Dragon in the Turbulent River (Konkōryū Rishun), from the series *One Hundred and Eight Heroes of the Popular Shuihuzhuan* (*Tsūzoku Suikoden gōketsu hyakuhachinin no hitori*)
By Utagawa Kuniyoshi

195 *Hikeshi Banten* (Fireman's Jacket) with Dragon and Tiger

Tokyo National Museum

196 Dragon and Tiger, from the series *Pictures of Birds and Beasts* (*Kinjū zue*)

By Utagawa Kuniyoshi

197 *Hikeshi Banten* (Fireman's Jacket) with Large Eagle

198 *Hikeshi Banten* (Fireman's Jacket) with Male Figure

Tokyo National Museum

199 *Hikeshi Banten* (Fireman's Jacket) with Scene of the Fight on the Roof of the Hōryūkaku, from *The Tale of Eight Dogs* (*Hakkenden*)

200 *Hikeshi Banten* (Fireman's Jacket) with Scene of Benkei on the Boat (*Funa Benkei*)

201 *Hikeshi Banten* (Fireman's Jacket) with Minamoto no Yorimasa Slaying the Nue Monster

No.	Title	Artist	Holder	Term
202	<i>Hikeshi Banten</i> (Fireman's Jacket) with the God Susano-o no Mikoto Slaying the Eight-Headed Dragon			
203	<i>Hikeshi Banten</i> (Fireman's Jacket) with Oniwakamaru (Warrior Benkei as a Youth) Subduing a Giant Carp			
204	Saitō Oniwakamaru (Warrior Benkei as a Youth)	By Utagawa Kuniyoshi		
205	<i>Hikeshi Banten</i> (Fireman's Jacket) with Kusunoki Tamonmaru (Warrior General Kusunoki Masashige as a Youth)			
206	Shi Jin, the Nine Dragoned (Kyūmonryū Shishin), and Chen Da, the Gorge-Leaping Tiger (Chōkanko Chintatsu), from the series <i>One Hundred and Eight Heroes of the Popular Shuihuzhuan</i> (<i>Tsūzoku Suikoden gōketsu hyakuhachinin no hitori</i>)	By Utagawa Kuniyoshi		
207	Yan Qing, the Graceful (Rōshi Ensei), from the series <i>One Hundred and Eight Heroes of the Popular Shuihuzhuan</i> (<i>Tsūzoku Suikoden gōketsu hyakuhachinin no ichinin</i>)	By Utagawa Kuniyoshi		
208, 209	Men of Ready Money with True Labels Attached, <i>Kuniyoshi Fashion</i> (<i>Kuniyoshi moyō shōfuda tsuketari genkin otoko</i>)	By Utagawa Kuniyoshi		
208	Nozarashi Gosuke			①–⑤
209-1	Banzui Chōbē			
209-2	Tōken Gonbē			
209-3	Nuregami Chōgorō			
209-4	Ume no Yoshibē			
209-5	Shirai Gonpachi			
209-6	Teranishi Kanshin			
209-7	Ude no Kisaburō			
209-8	Goshaku Somegorō			
209-9	Danshichi Kurōbē			
5. Natty Men's Accessories: Inro, Netsuke, Tobacco Cases, and Pipe Containers				
210	Inro		Tokyo National Museum	
211	Netsuke		Tokyo National Museum	
212	Mirror Case with Floral Arabesques		Tokyo National Museum	
213	Tobacco Pouch and Pipe Container Set		Tokyo National Museum	
214	Tobacco Holder		Tokyo National Museum	
Part IV Modern Kimono: Meiji, Taishō, and Early Shōwa Periods (1868–1940s)				
1. Democratizing Fashion				
215	<i>Furisode</i> (Long-Sleeved Kimono) with Flowers and Plants		National Museum of Japanese History, Chiba	①–④
216	<i>Hitoe</i> (Unlined Kimono) with Banana Tree with Autumn Flowers and Plants		National Museum of Japanese History, Chiba	⑤–⑧
217	<i>Hitoe</i> (Unlined Kimono) with Dragon Palace under the Sea		National Museum of Japanese History, Chiba	
218	<i>Uchikake</i> (Outer Kimono) with a Hundred Birds		Kyoto National Museum	
219	<i>Furisode</i> (Long-Sleeved Kimono) with Flowing Water and a Hundred Flowers			
220	Kimono with Design of Prints by Utamaro		Marubeni Corporation, Tokyo	
221	Kimono with Birds and Flowers		National Museum of Japanese History, Chiba	
222	<i>Uchikake</i> (Outer Kimono) with Cart Holding Seasonal Flowers		Marubeni Corporation, Tokyo	
223	<i>Furisode</i> (Long-Sleeved Kimono) with Cart Holding Seasonal Flowers		Marubeni Corporation, Tokyo	

No.	Title	Artist	Holder	Term
224	<i>Furisode</i> (Long-Sleeved Kimono) with Imaginary Dutch Scenery		Marubeni Corporation, Tokyo	
225	<i>Furisode</i> (Long-Sleeved Kimono) with Flower Baskets		National Museum of Japanese History, Chiba	
226	<i>Furisode</i> (Long-Sleeved Kimono) with Western-style Palace Designs		National Museum of Japanese History, Chiba	
227	<i>Maru Obi</i> with Chintz (<i>Sarasa</i>) Patterns		Marubeni Corporation, Tokyo	
228	Obi with <i>Shōkko</i> Geometric Pattern		National Museum of Japanese History, Chiba	
229	<i>Obidome</i> (Sash Ornaments)			
230	Hair Ornaments			
231	Passersby	By Takabatake Kashō		
232	Taishō and Shōwa Period Kimono and Obi Coordinated Ensembles			No. 232-1, 2: ①–⑧ No. 232-4 ~ 11: ①–④ No. 232-3, 12 ~ 18: ⑤–⑧
233	<i>Meisen</i> Kimono with Stripes and Geometric Patterns			
234	<i>Meisen</i> Kimono with Illumination Pattern			
235	<i>Meisen</i> Kimono with Abstract Geometric Patterns			
236	<i>Meisen</i> Kimono with Lozenge Stripes			①–④
237	<i>Meisen Haori</i> (Jacket) with Doves			①–④
238	<i>Meisen</i> Kimono with Flowers and Leaves in Checkers			①–④
239	<i>Meisen Haori</i> (Jacket) with Checks and Flowering Vines Arabesques over Lattice Petern			①–④
240	<i>Meisen</i> Kimono with Checkers and Arabesques			①–④
241	<i>Meisen Haori</i> (Jacket) with Mountain Landscape Scenery			①–④
242	<i>Meisen</i> Kimono with Ribbons			①–④
243	<i>Meisen Haori</i> (Jacket) with Checks			①–④
244	<i>Meisen</i> Kimono with Ōshima-style Floral Arabesques			①–④
245	<i>Meisen Haori</i> (Jacket) with Flowers on Frosted Ground			①–④
246	<i>Meisen</i> Kimono with Abstracted Walking Paths			
247	<i>Meisen Haori</i> (Jacket) with Houses through Windows			①–④
248	<i>Meisen Hitoe</i> (Unlined Kimono) with Flower Bouquets and Waves			⑤–⑧
249	<i>Meisen Hitoe</i> (Unlined Kimono) with Spirals			⑤–⑧
250	<i>Meisen Hitoe</i> (Unlined Kimono) with Roses			⑤–⑧
251	<i>Meisen Hitoe</i> (Unlined Kimono) with Flowers and Flowing Water			⑤–⑧
252	<i>Meisen Hitoe</i> (Unlined Kimono) with Chrysanthemums			⑤–⑧
253	Woman (Design for “Genuine Ashikaga <i>Meisen</i> ” Poster)	By Itō Shinsui	Ashikaga Museum of Art, Tochigi	
254	Modern Woman (Design for “Genuine Ashikaga <i>Meisen</i> ” Poster)	By Kitano Tsunetomi	Ashikaga Museum of Art, Tochigi	
255	Woman (Design for “Genuine Ashikaga <i>Meisen</i> ” Poster)	By Kaburaki Kiyokata	Ashikaga Museum of Art, Tochigi	
256	Woman (Design for “Genuine Ashikaga <i>Meisen</i> ” Poster)	By Yamakawa Shūhō	Ashikaga Museum of Art, Tochigi	
257	Woman (Design for “Genuine Ashikaga <i>Meisen</i> ” Poster)	By Nakamura Daizaburō	Ashikaga Museum of Art, Tochigi	
2. Modern Design				
258	Kimono with Modern-style Scattered Flowers			

No.	Title	Artist	Holder	Term
259	Kimono with Sunflowers and Evening Primroses			
260	Kimono with Ravens and Willow			
261	Kimono with Doves in a Cedar Grove			
262	Kimono with Chintz (<i>Sarasa</i>) Patterns			
263	Obi with White Peacock			
264	Obi with Peacock and Roses			
265	Obi with Horned Owl			
266	<i>Meisen</i> Kimono with Camellias	Saitama Prefectural Museum of History and Folklore		①-④
267	<i>Meisen</i> Kimono with Shepherd's Purse Design	Saitama Prefectural Museum of History and Folklore		①-④
268	<i>Meisen</i> Kimono with Peonies	Saitama Prefectural Museum of History and Folklore		①-④
269	<i>Meisen</i> Kimono with Roses	Saitama Prefectural Museum of History and Folklore		⑤-⑧
270	<i>Meisen</i> Kimono with Sunflowers	Saitama Prefectural Museum of History and Folklore		⑤-⑧
271	<i>Meisen</i> Kimono with Maple Leaves	Saitama Prefectural Museum of History and Folklore		⑤-⑧
272	<i>Meisen</i> Kimono with Chrysanthemum Design	Saitama Prefectural Museum of History and Folklore		
273	<i>Meisen</i> Kimono with Sails	Saitama Prefectural Museum of History and Folklore		
274	<i>Meisen Haori</i> (Jacket) with Tennis Racquets	Saitama Prefectural Museum of History and Folklore		①-④
275	<i>Meisen</i> Kimono with Streetlights	Saitama Prefectural Museum of History and Folklore		①-④
276	<i>Meisen</i> Kimono with Dots	Saitama Prefectural Museum of History and Folklore		
277	<i>Meisen</i> Kimono with Flowers and Abstracted Scenery			⑤-⑧
278	<i>Meisen Haori</i> (Jacket) with Roses and Lozenges			⑤-⑧

No.	Title	Artist	Holder	Term
Part V Kimono Today				
1. Tarō Kimono				
279	Taro Kimono and Obi Ensemble	Design by Okamoto Tarō	Taro Okamoto Memorial Museum, Tokyo	
2. The Installations of Kubota Itchiku				
280	<i>Gen</i> , Floral Illusion, a Creation of the Spirit of the Cherry Blossom	By Kubota Itchiku		
281	Symphony of Light	By Kubota Itchiku	International Chodiev Foundation, United Kingdom	
3. Tradition and Innovation: Textile Artists Designated Living National Treasures				
282	<i>Yūzen</i> Kimono, <i>Thousand Flowers</i>	By Moriguchi Kunihiro		①-④
283	<i>Yūzen</i> Kimono, <i>Green Shadows</i>	By Moriguchi Kunihiro		①-④
284	<i>Yūzen</i> Kimono, <i>Fruiting</i>	By Moriguchi Kunihiro	Isetan Mitsukoshi Ltd., Tokyo	①-④
285	<i>Yūzen</i> Kimono, <i>Willow Green Basketry</i>	By Moriguchi Kunihiro	Agency for Cultural Affairs	⑤-⑧
286	<i>Yūzen</i> Kimono, <i>Floral Lozenges</i>	By Moriguchi Kunihiro	Agency for Cultural Affairs	⑤-⑧
287	<i>Yūzen</i> Kimono, <i>Layered Floral Scales</i>	By Moriguchi Kunihiro	Agency for Cultural Affairs	⑤-⑧
288	Kimono, <i>Red Raven</i>	By Tsuchiya Yoshinori	Tokyo Kasei University Museum	
289	Kimono, <i>Sounds of a Moonlit Mountain Stream</i>	By Tsuchiya Yoshinori	Agency for Cultural Affairs	
290	Kimono, <i>Spirit of the Rose</i>	By Tsuchiya Yoshinori		
291	Kimono, <i>Tranquility of Trees</i>	By Suzuta Shigeto	Tokyo National Museum	
292	Kimono, <i>St. John's Wort Blossoms</i>	By Suzuta Shigeto		
293	Kimono, <i>Soaring Floral Patterns</i>	By Suzuta Shigeto		
4. YOSHIKIMONO				
294	YOSHIKIMONO	Design by YOSHIKI		

Floor Plan | Heiseikan 2F

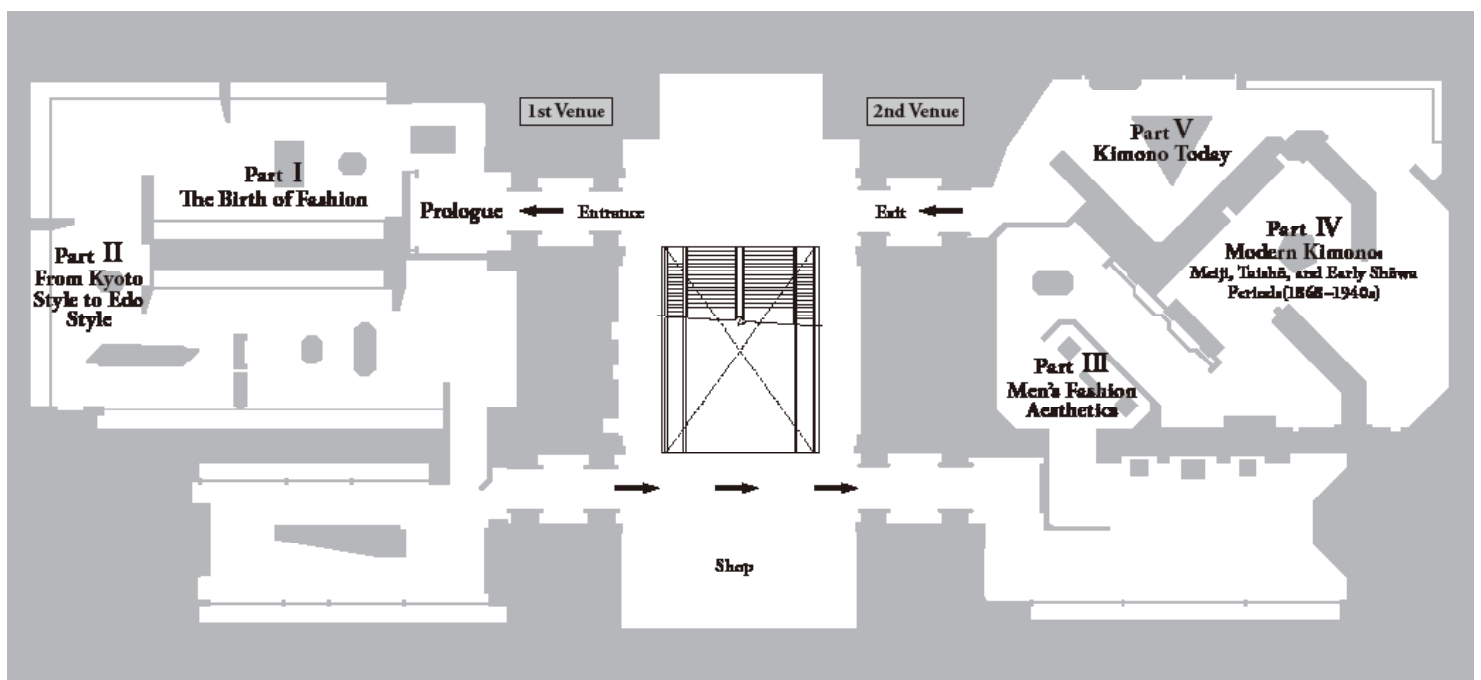

*Temperature, humidity and brightness of the exhibition rooms are strictly controlled under international standards for preservation reasons. We apologize for any inconvenience this may cause.

