

Special Exhibition
Celebrating the Completion of Conservation Work
on Jōruriji Temple’s Amida Statues

List of Works



Buddhist Sculptures from Minami Yamashiro in Kyoto

September 16–November 12, 2023

Room T5 of the Honkan (Japanese Gallery), Tokyo National Museum

Organized by Tokyo National Museum, Nikkei Inc., TV TOKYO Corporation, BS TV TOKYO Corporation

Sponsored by Central Japan Railway Company, TAKENAKA CORPORATION, Nissha Co., Ltd.

With special support from The Association of Ancient Temples in Minami Yamashiro

- Notes
- The same artwork numbers are used in both the catalogue and the galleries, but the works are not displayed in numerical order.
 - Key to symbols on illustrations: ●=National Treasure, ◎=Important Cultural Property.
 - Some artworks may be rotated during the exhibition period. Exhibition lineup may change as circumstances require.
 - Works are on view throughout the exhibition period unless otherwise indicated.

No.	Designation	Title	Creator	Materials and production techniques	Period and century	Ownership	On view		
1	◎	Standing Eleven-Headed Kannon Bosatsu (Ekādaśamukha)		Wood	Heian period, 9th century	Kaijūsenji Temple, Kyoto			
2	◎	Standing Yakushi Nyorai (Bhaiṣajyaguru)		Wood	Heian period, 9th century	Amidaji Temple, Kyoto			
3	◎	Seated Yakushi Nyorai (Bhaiṣajyaguru)		Wood with lacquer and gold foil	Heian period, 9th century	Yakushiji Temple, Kyoto			
4	◎	Standing Eleven-Headed Kannon Bosatsu (Ekādaśamukha)		Wood with lacquer and gold foil	Heian period, 10th century	Zenjōji Temple, Kyoto			
5	◎	Monju Bosatsu (Mañjuśrī) Riding a Lion		Wood with polychromy	Heian period, 10th century	Zenjōji Temple, Kyoto			
6	◎	Fugen Bosatsu (Samantabhadra) Riding an Elephant		Wood with polychromy and <i>kirikane</i> cut gold leaf	Heian period, 11th century	Gansenji Temple, Kyoto			
7	◎	Seated Yakushi Nyorai (Bhaiṣajyaguru)		Wood with lacquer, gold foil, and polychromy	Heian period, 11th century	Jōruriji Temple, Kyoto		10/11~10/26	
8	◎	Standing Jizō Bosatsu (Kṣitigarbha)		Wood with polychromy and <i>kirikane</i> cut gold leaf	Heian period, 12th century	Jōruriji Temple, Kyoto	9/16~10/9		10/27~11/12
9	●	Seated Amida Nyorai (Amitābha) (from a set of nine Amida statues)		Wood with lacquer and gold foil	Heian period, 12th century	Jōruriji Temple, Kyoto			
10	●	Standing Kōmōkuten (Virūpākṣa) (from a set of the Four Heavenly Kings)		Wood with polychromy and <i>kirikane</i> cut gold leaf	Heian period, 11th–12th century	Jōruriji Temple, Kyoto			
11	●	Standing Tamonten (Vaiśravaṇa) (from a set of the Four Heavenly Kings)		Wood with polychromy and <i>kirikane</i> cut gold leaf	Heian period, 11th–12th century	Jōruriji Temple, Kyoto			
12	◎	Standing Fudō Myōō (Wisdom King Acala)		Wood with polychromy	Heian period, 12th century	Jindōji Temple, Kyoto			
13	◎	Standing Thousand-Armed Kannon Bosatsu (Avalokiteśvara)		Wood	Heian period, 12th century	Juhōji Temple, Kyoto			
14		Standing Kongōyasha Myōō (Wisdom King Vajrayakṣa)		Wood with polychromy	Heian period, 12th century	Juhōji Temple, Kyoto			
15		Standing Gōzanze Myōō (Wisdom King Trailokyavijaya)		Wood with polychromy	Heian period, 12th century	Juhōji Temple, Kyoto			
16		Seated Gozu Tennō (Ox-headed Deity)		Wood with polychromy	Heian period, 12th century	Matsuo-jinja Shrine, Kyoto			
17	◎	Seated Eleven-Headed Kannon Bosatsu (Ekādaśamukha)		Wood with lacquer, gold foil, and rock crystal eyes	Kamakura period, 13th century	Genkōji Temple, Kyoto			
18	◎	Standing Amida Nyorai (Amitābha)	By Gyōkai	Wood with lacquer, gold foil, and rock crystal eyes	Kamakura period, dated 1227	Gokurakuji Temple, Kyoto			

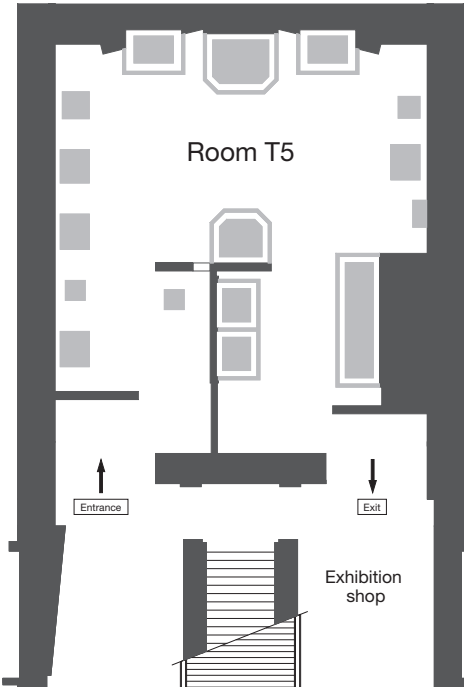
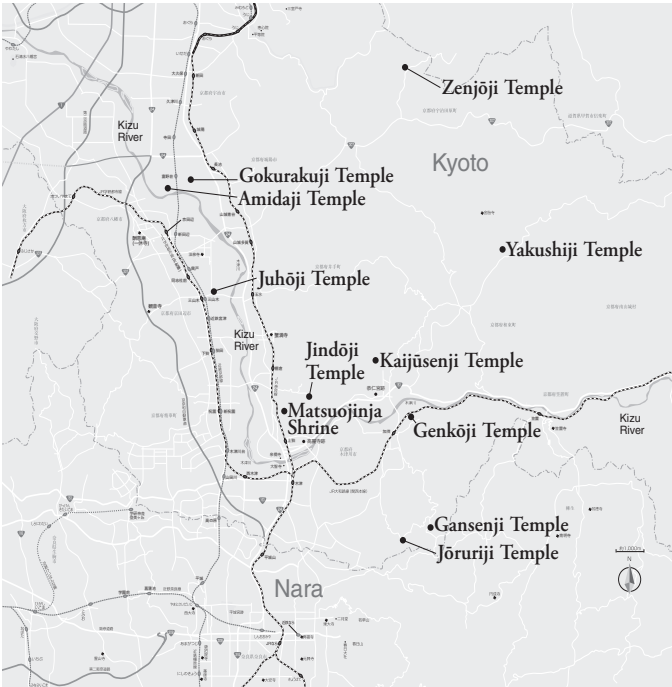

* Temperature, humidity and brightness of the exhibition room are strictly controlled under international standards for preservation reasons. We apologize for any inconvenience this may cause.

