

# Floor Map: Toyokan (Asian Gallery)

## 5th floor

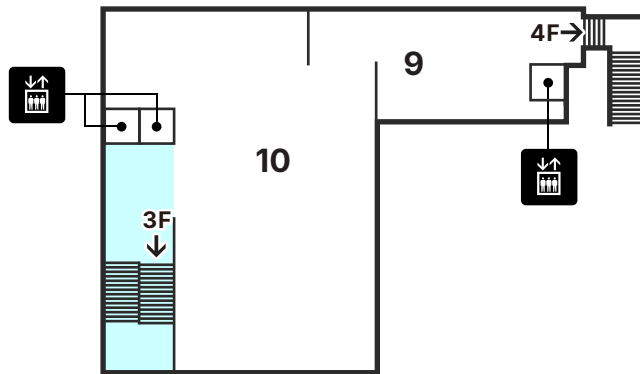

**9** : Chinese Lacquerware, Decorative Art of the Qing Dynasty **10** : Polished Stone and Metal Tools of the Korean Peninsula, The Rise and Fall of Kings on the Korean Peninsula, Ceramics of the Korean Peninsula, Buddhist Art of the Korean Peninsula, Art of the Joseon Dynasty

## 4th floor

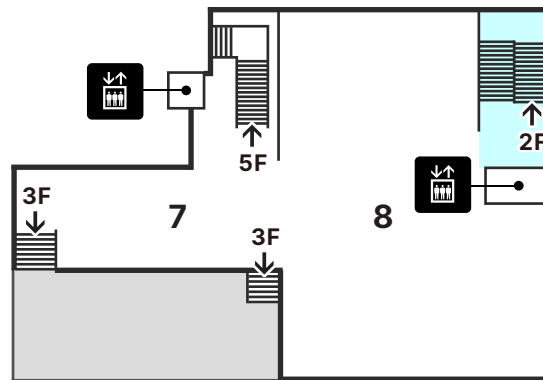

**7** : Stone Relief Carvings of China **8** : Chinese Painting, Chinese Calligraphy, Chinese Literati

## 3rd floor

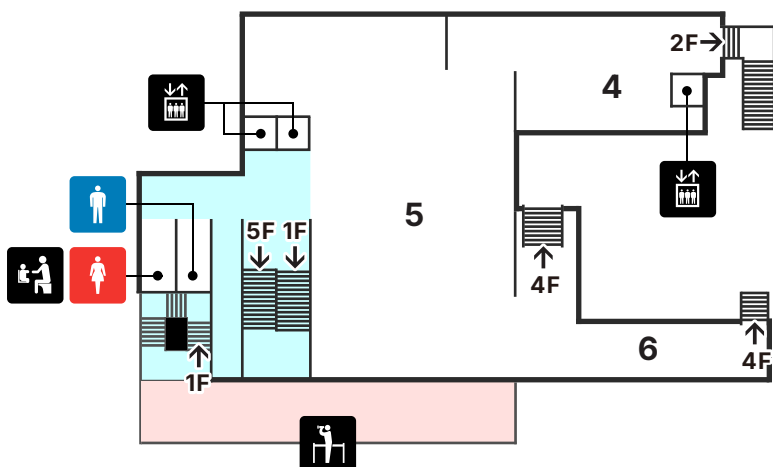

**4** : The Advent of Chinese Civilization **5** : Chinese Bronzes, Burials in China, Chinese Ceramics, Chinese Textiles **6** : Education Space: *Fortune-telling in Asia*

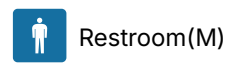

Restroom(M)



Restroom(F)



Restroom (accessible)



Information



Coin Lockers



Restaurant



Café



Vending Machines



Museum Shop



Elevator



Payphone



AED (Automatic External Defibrillators)



Diaper Change Facilities



Baby Chair



Day-care Room



Nursing Room



Aid Station Nursing Room



Ostomate Facilities



Braille Information



Small Whiteboard (For communication)



Wheelchairs Available



Viewpoint



Lounge



Drinking Fountain



No food. Lidded drinks only.



Food & drinks allowed

# Floor Map: Toyokan (Asian Gallery)

## 2nd floor

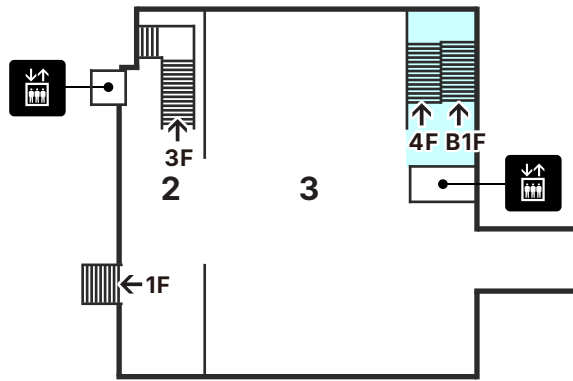

**2** : Education Space: *Journey Information* **3** : Egypt and Western Asia, Sculptures from India and Gandhara, Art of the Western Regions

## 1st floor

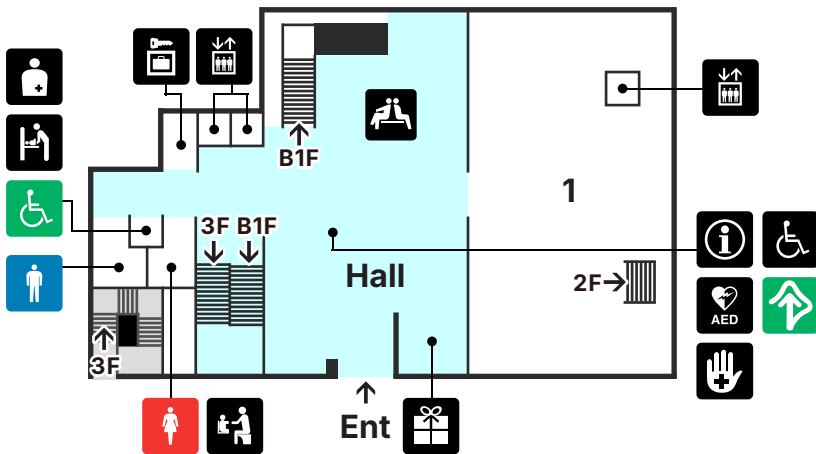

**Ent** : Entrance **Hall** : Entrance hall **1** : Chinese Buddhist Sculpture

## Basement

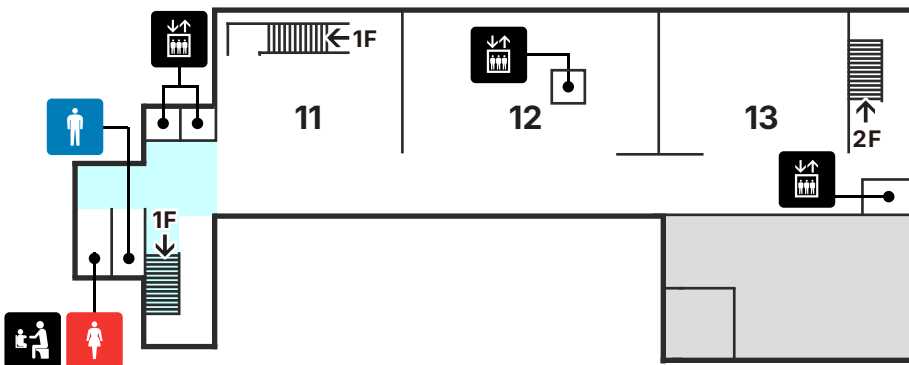

**11**: Khmer Sculpture **12** : Sculptures from Southeast Asia, Archaeology of India and Southeast Asia, Southeast Asian Ceramics **13** : Asian Textiles, Indian Miniature Paintings, Ethnic Cultures of Asia

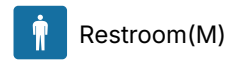

Restroom(M)



Restroom(F)



Restroom (accessible)



Information



Coin Lockers



Restaurant



Café



Vending Machines



Museum Shop



Elevator



Payphone



AED (Automatic External Defibrillators)



Diaper Change Facilities



Baby Chair



Day-care Room



Nursing Room



Aid Station Nursing Room



Ostomate Facilities



Braille Information



Small Whiteboard (For communication)



Wheelchairs Available



Viewpoint



Lounge



Drinking Fountain

No food. Lidded drinks only.

Food & drinks allowed